

| polohy zařízení | | |
|-----------------|------------|-------------|
| bod | Y= | X= |
| 1 | 747 170.58 | 1017 317.90 |
| 2 | 747 154.74 | 1017 358.41 |
| 3 | 747 140.21 | 1017 399.96 |
| 4 | 747 136.72 | 1017 407.12 |
| 5 | 747 126.15 | 1017 436.61 |
| 6 | 747 111.76 | 1017 473.13 |
| 7 | 747 096.03 | 1017 514.22 |
| 8 | 747 096.21 | 1017 534.50 |
| 9 | 747 087.11 | 1017 556.43 |
| 10 | 747 068.53 | 1017 550.71 |
| 11 | 747 066.22 | 1017 560.05 |
| 12 | 747 024.50 | 1017 607.43 |
| 13 | 746 996.63 | 1017 577.23 |
| 14 | 746 966.11 | 1017 549.83 |
| 15 | 747 020.24 | 1017 623.97 |
| 16 | 746 983.85 | 1017 590.88 |
| 17 | 746 955.97 | 1017 560.67 |
| 18 | 747 052.70 | 1017 624.99 |
| 19 | 747 038.36 | 1017 657.98 |
| 20 | 747 036.55 | 1017 665.92 |
| 21 | 747 025.31 | 1017 639.85 |
| 22 | 747 020.73 | 1017 704.62 |
| 23 | 747 006.25 | 1017 743.83 |
| 24 | 746 992.90 | 1017 774.85 |
| 25 | 746 991.09 | 1017 782.79 |
| 26 | 746 965.96 | 1017 789.34 |
| 27 | 746 975.21 | 1017 823.82 |
| 28 | 746 959.82 | 1017 865.04 |
| 29 | 746 909.21 | 1018 261.39 |
| 30 | 746 915.21 | 1018 266.80 |
| 31 | 746 981.43 | 1018 347.02 |
| 32 | 746 986.88 | 1018 353.68 |
| 33 | 747 067.80 | 1018 449.93 |
| 34 | 747 072.64 | 1018 456.31 |
| 35 | 747 097.25 | 1018 485.16 |
| 36 | 747 118.40 | 1018 510.68 |
| 37 | 747 139.55 | 1018 536.19 |
| 38 | 747 176.70 | 1018 573.72 |
| 39 | 747 202.99 | 1018 627.68 |
| 40 | 747 227.46 | 1018 680.25 |
| 41 | 747 252.29 | 1018 732.67 |
| 42 | 747 287.62 | 1018 799.23 |
| 43 | 747 325.06 | 1018 885.63 |
| 44 | 747 352.79 | 1018 945.35 |
| 45 | 747 377.01 | 1018 998.06 |
| 50 | 747 161.08 | 1017 342.18 |
| 51 | 747 158.41 | 1017 349.02 |
| 52 | 747 152.30 | 1017 364.64 |
| 53 | 747 150.27 | 1017 369.84 |
| 54 | 747 137.24 | 1017 411.52 |
| 55 | 747 133.26 | 1017 421.88 |
| 56 | 747 079.52 | 1017 557.17 |
| 57 | 747 067.29 | 1017 552.37 |
| 58 | 747 057.72 | 1017 605.71 |
| 59 | 747 048.33 | 1017 602.06 |
| 60 | 747 044.34 | 1017 600.50 |
| 61 | 747 035.43 | 1017 597.04 |
| 62 | 747 025.72 | 1017 605.02 |
| 63 | 747 024.12 | 1017 605.63 |
| 64 | 747 023.33 | 1017 606.46 |
| 65 | 747 015.16 | 1017 617.42 |
| 66 | 746 982.75 | 1017 563.49 |

| | | |
|-----|------------|-------------|
| 67 | 746 970.59 | 1017 552.92 |
| 68 | 746 974.45 | 1017 591.10 |
| 69 | 746 963.93 | 1017 580.95 |
| 70 | 747 053.00 | 1017 629.96 |
| 71 | 747 050.78 | 1017 635.56 |
| 72 | 747 039.72 | 1017 660.83 |
| 73 | 747 038.17 | 1017 664.34 |
| 74 | 747 034.21 | 1017 667.16 |
| 75 | 747 022.59 | 1017 662.65 |
| 76 | 747 032.54 | 1017 678.40 |
| 77 | 747 030.76 | 1017 682.85 |
| 78 | 747 026.21 | 1017 694.19 |
| 79 | 747 023.54 | 1017 700.84 |
| 80 | 746 995.15 | 1017 778.17 |
| 81 | 746 993.93 | 1017 781.71 |
| 82 | 746 989.68 | 1017 780.65 |
| 83 | 746 980.25 | 1017 777.00 |
| 84 | 746 967.59 | 1017 778.19 |
| 85 | 746 967.92 | 1017 788.65 |
| 86 | 746 906.46 | 1018 237.67 |
| 87 | 746 909.98 | 1018 241.86 |
| 88 | 746 925.08 | 1018 261.29 |
| 89 | 746 916.70 | 1018 268.16 |
| 90 | 746 927.06 | 1018 262.96 |
| 91 | 746 932.93 | 1018 267.95 |
| 92 | 746 986.37 | 1018 352.80 |
| 93 | 746 993.99 | 1018 346.56 |
| 94 | 746 997.37 | 1018 350.21 |
| 95 | 747 002.22 | 1018 356.75 |
| 96 | 747 073.94 | 1018 442.80 |
| 97 | 747 067.51 | 1018 448.16 |
| 98 | 747 075.27 | 1018 457.72 |
| 99 | 747 079.19 | 1018 462.43 |
| 100 | 747 082.51 | 1018 466.41 |
| 101 | 747 084.96 | 1018 469.36 |
| 102 | 747 087.92 | 1018 472.91 |
| 103 | 747 093.46 | 1018 479.56 |
| 104 | 747 099.14 | 1018 486.28 |
| 105 | 747 102.72 | 1018 490.57 |
| 106 | 747 114.77 | 1018 504.97 |
| 107 | 747 117.66 | 1018 508.44 |
| 108 | 747 123.24 | 1018 515.11 |
| 109 | 747 126.76 | 1018 519.33 |
| 110 | 747 132.09 | 1018 525.64 |
| 111 | 747 135.19 | 1018 529.38 |
| 112 | 747 142.20 | 1018 537.86 |
| 113 | 747 146.56 | 1018 543.71 |
| 114 | 747 155.82 | 1018 558.08 |
| 115 | 747 164.66 | 1018 554.68 |
| 116 | 747 186.25 | 1018 593.19 |
| 117 | 747 189.81 | 1018 601.13 |
| 118 | 747 206.77 | 1018 636.31 |
| 119 | 747 208.86 | 1018 640.78 |
| 120 | 747 277.12 | 1018 785.74 |
| 121 | 747 284.88 | 1018 801.60 |
| 122 | 747 309.08 | 1018 856.21 |
| 123 | 747 314.72 | 1018 868.23 |
| 124 | 747 339.60 | 1018 921.40 |
| 125 | 747 344.19 | 1018 931.21 |
| 126 | 747 353.49 | 1018 951.08 |
| 127 | 747 355.64 | 1018 955.79 |
| 128 | 747 362.91 | 1018 970.23 |
| 129 | 747 376.30 | 1018 999.37 |

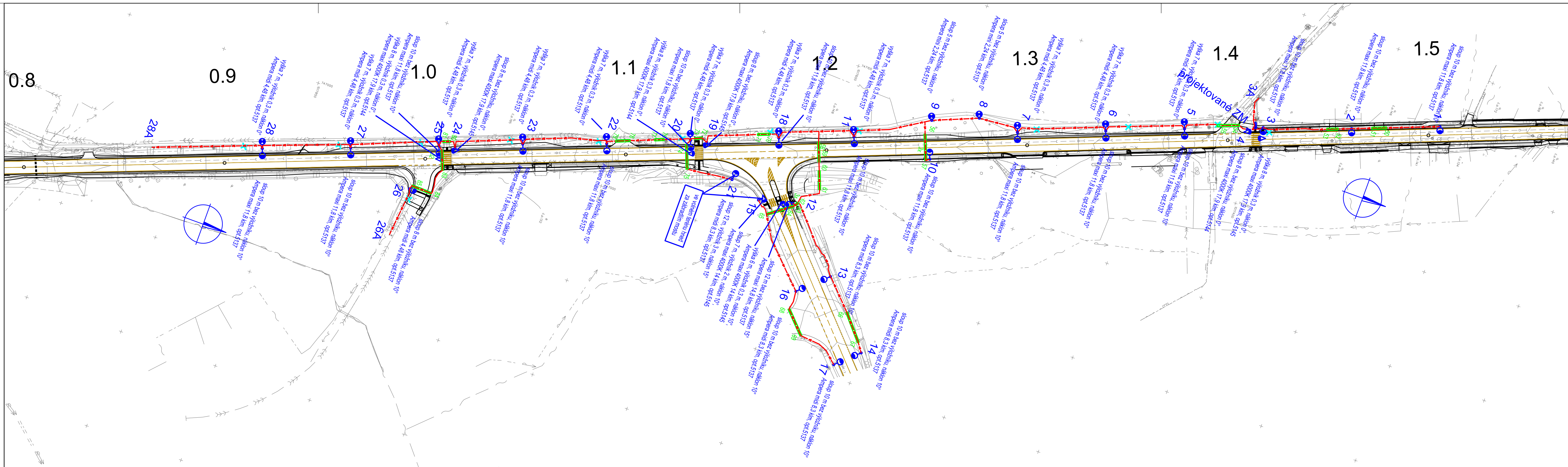

- bourat sloup
- demontovat svítidlo na sloupu jiného správce
- kabel v pískovém loži se zakrytím
- kabel v chráněné trubce obetonovaná (pokud není uvedeno jinak dvouotvorová)
- sloup veřejného osvětlení

napájecí soustava:
3+PEN střídavého 50 Hz 400 V / TN-C

| | |
|--|----------|
| Souřadnicový systém S-JTSK, Výškový systém Bpv | |
| Zhotovitel: | objekt: |
| 431 | |
| Příloha: | Měřítko: |
| situace konec úseku | |
| 1:1000 | |
| Číslo přílohy: | |
| 4 | |

výtiskeno dne 04.12.2019