

Objednatel stavby:



Krajská správa a údržba silnic Středočeského kraje, p.o.

Zborovská 11, 150 21 Praha 5
IČ: 000 66 001

Souřadnicový systém: S-JTSK
Výškový systém: Bpv

ČÁST D

Číslo zakázky:	17 236 00	HIP:	Ing. Petr SOUČEK	 Praha 4, Bezová 1658, 147 14 tel: +420 244062215 fax: +420 244461038 e-mail: pontex@pontex.cz
Schválil:	Ing. Václav HVÍZDAL		602214618, soucek@pontex.cz	
		Zodp. projektant:	Ing. Jan BAŽIL	
			727970803, bazil@pontex.cz	
Tech. kontrola:	Ing. Ondřej DĚDEK	Vypracoval:	Ing. Jan BAŽIL	
			727970803, bazil@pontex.cz	

Objednatel:	KSUS Středočeského kraje	Obec:	Benátky nad Jizerou	Kraj:	Středočeský
Akce:	II/610 Benátky n/J, most ev.č. 610-021a přes D10 před obcí Benátky n/J a oprava přilehlé komunikace ve staničení 22,353 km – 24,853 km – PD			Datum	Stupeň
				05/2018	PDPS
				Souprava	Č. přílohy
Příloha:	GEODETICKÁ DOKUMENTACE				D.2



GRV

Špindlerova třída 688, Roudnice nad Labem

Zpracoval:

Ing. Martin
Kapitančík

Ověřil:

Ing. Miloslav Krejný

Kraj:

Středočeský

Okres:

Mladá Boleslav

K.ú.:

Staré Benátky

Souř.sys.:

S-JTSK

Výškový sys.:

Bpv

Objednavatel:

Pontex s.r.o., Bezová 1658/1, 14700 Praha

ZAMĚŘENÍ POLOHOPISU A VÝŠKOPISU

Obsah:

Geodetické zaměření

Technická zpráva

1. Informace o zakázce

<u>Zakázka:</u>	<i>Zaměření polohopisu a výškopisu</i>
<u>Číslo zakázky:</u>	<i>538/2017</i>
<u>Katastrální území:</u>	<i>Staré Benátky</i>
<u>Obec:</u>	<i>Benátky nad Jizerou</i>
<u>Okres:</u>	<i>Mladá Boleslav</i>
<u>Odběratel:</u>	<i>Pontex s.r.o., Bezová 1658/1, 14700 Praha</i>
<u>Dodavatel:</u>	<i>GRV Engineering s.r.o., Špindlerova třída 688, 413 01 Roudnice nad Labem</i>
<u>Souřadnicový systém:</u>	<i>S-JTSK</i>
<u>Výškový systém:</u>	<i>BpV</i>

2. Zadání

Předmětem zakázky je polohopisné a výškopisné zaměření komunikace II/610 a mostu 610-021A. Mapovaná lokalita se nachází převážně v extravilánu obce. V terénu byla zaměřena komunikace a nejbližší okolí. Rozsah zaměřeného území byl stanoven projektantem. Zaměření bylo provedeno v září 2017.

3. Způsob zpracování

Polohově a výškově bylo měření připojeno na pomocné měřické body 4001 až 4030 které byly určeny pomocí GNSS. Měření GNSS bylo provedeno na každém bodě dvakrát, v intervalu mezi měřeními v řádu hodin (viz. protokol měření GNSS v archivu zhotovitele). Podrobné měření bylo provedeno polární metodou z připraveného bodového pole. Použité přístroje a metoda nám umožňují zařadit podrobné měření do 3.třídy přesnosti podle ČSN 013410 "Mapy velkých měřítek - základní ustanovení", tj. $m_{xy}=0.14m$ a $m_{xv}=0.12m$.

4. kancelářské práce

Souřadnice byly vypočteny v programu Groma v.7 . Zpracování zakázky proběhlo v programu Kokeš v.12.66. Kresba byla vyexportována do formátu *.DWG.

5. Vlastnické hranice

Vlastnické hranice byly získány na podkladě digitální katastrální mapy (DKM).













6. Použité přístroje a pomůcky

Totální stanice: **Leica TS15 P1" R400** v.č.: 1668266
+ stativ Leica, odrazný hranol 360°, odrazný mini-hranol 360°

GNSS aparatura: **CHC X91**
+ výtyčka

V Roudnice nad Labem 9. 10. 2017

Ing. Martin Kapitančík

LEGENDA	
	hranica komunikácie
	hranica povrchu
	os komunikácie
	terénne hrany
	hranica obrubníkov
	zvodidlo
	ploty, zdi a vrata dřevěný
	ploty, zdi a vrata drátěný, kovový
	PRIS
	zábradlí
	jednotlivý strom
	šachta hranatá
	dopravná značka
	stožiar kovový, betónový, dřevěný

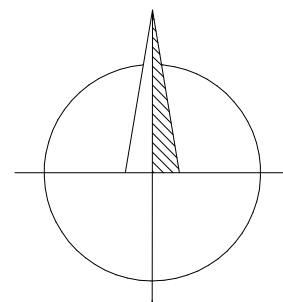

Zpracovatel : GRV Engineering s.r.o. Špindlerova třída 688, Roudnice n/L www.grv.cz	ZAMĚŘENÍ POLOHOPISU A VÝŠKOPISU	
	Obec : Benátky nad Jizerou	Měřítko : 1:500
Číslo zakázky : 538/2017	Katastrální území: Staré Benátky	Souř. systém : S-JTSK
Zaměřil : Ing. Martin Kapitančík	Přístroj : Leica TS15, CHC X91	Výškový systém : Bpv
Vyhotovil : Ing. Martin Kapitančík	Objednavatel: Pontex, spol. s.r.o., Bezová 1658/1, 14700 Praha	



430/1

Výkres 1

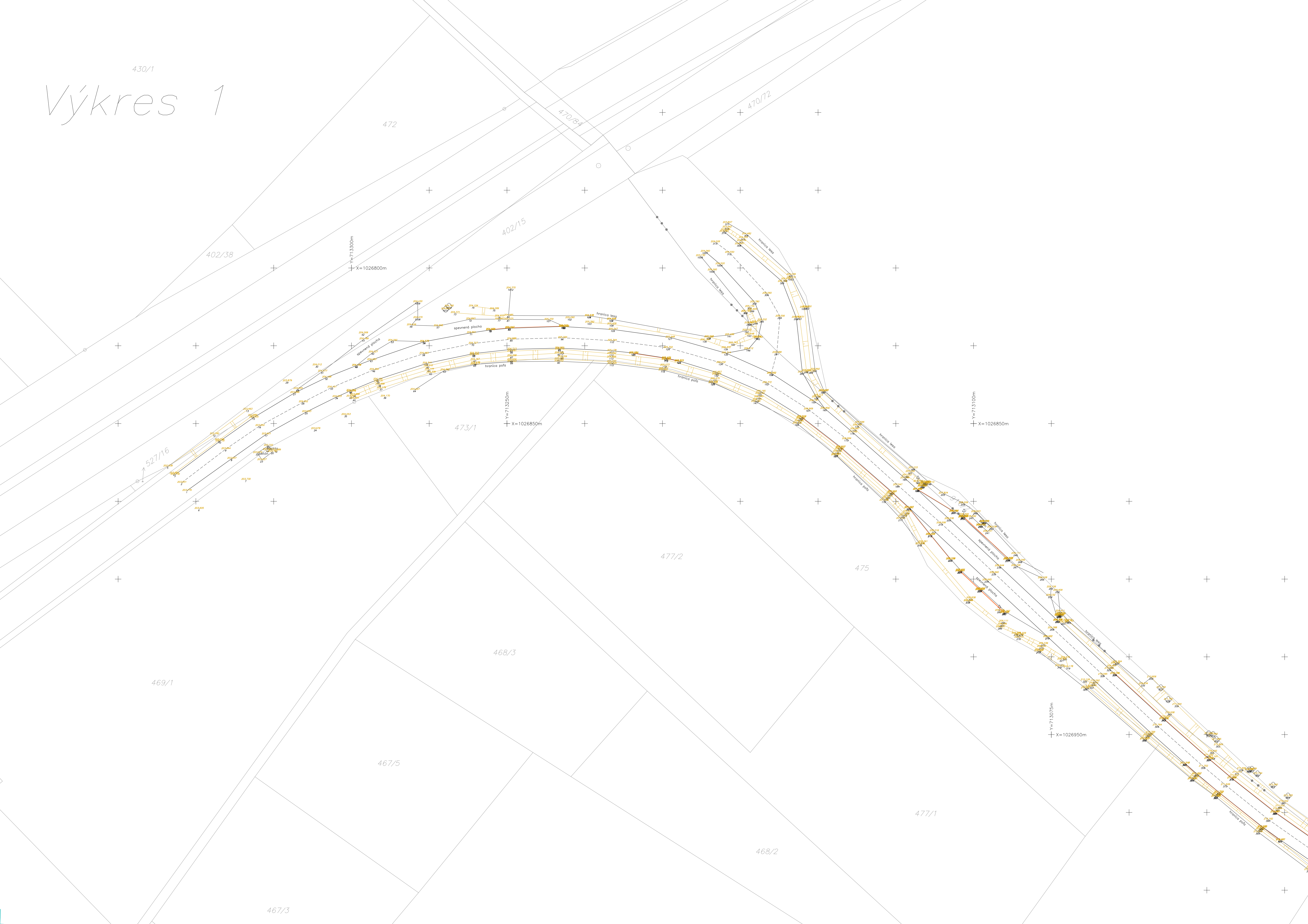

Výkres 2

Výkres 3

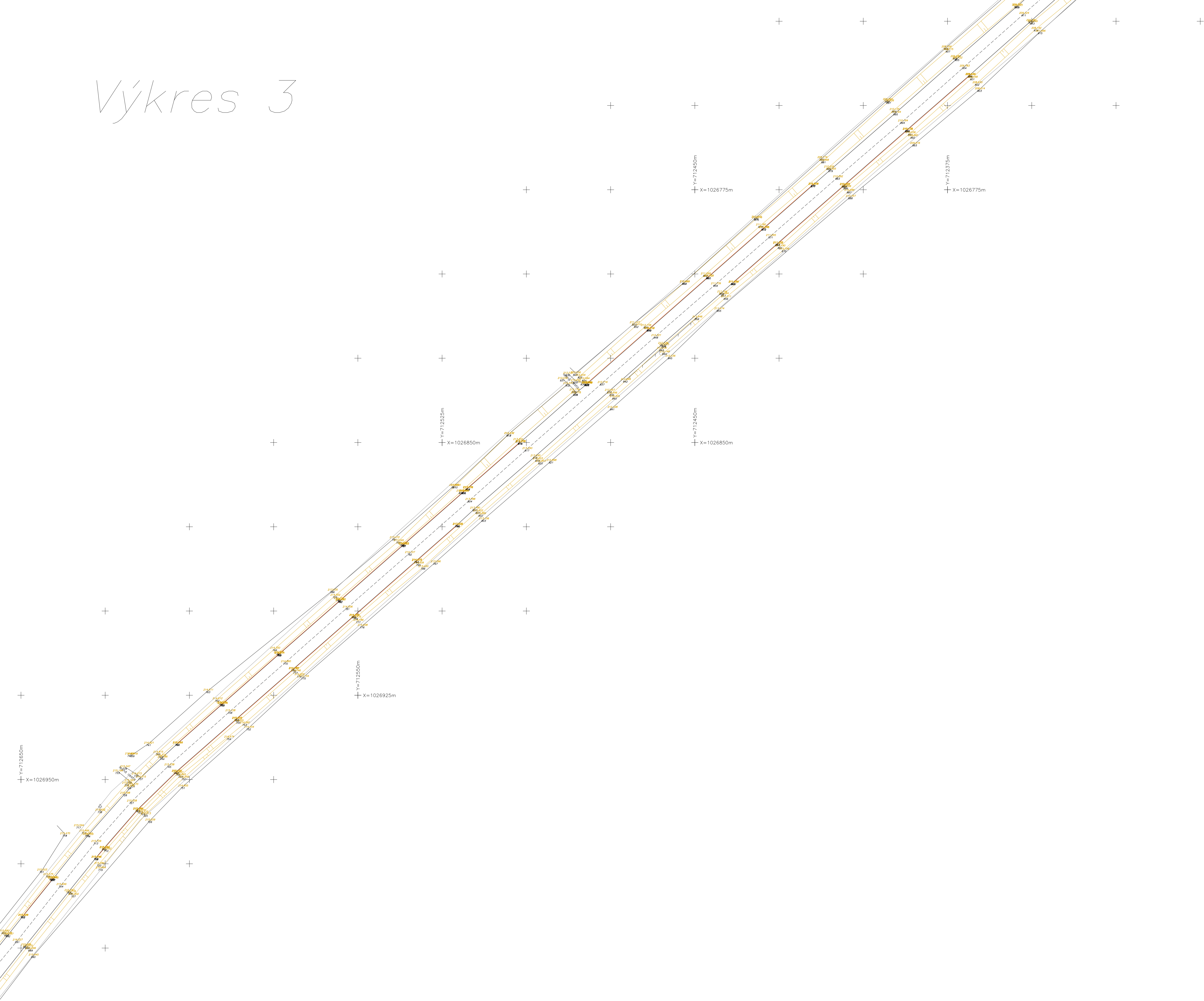

Výkres 4

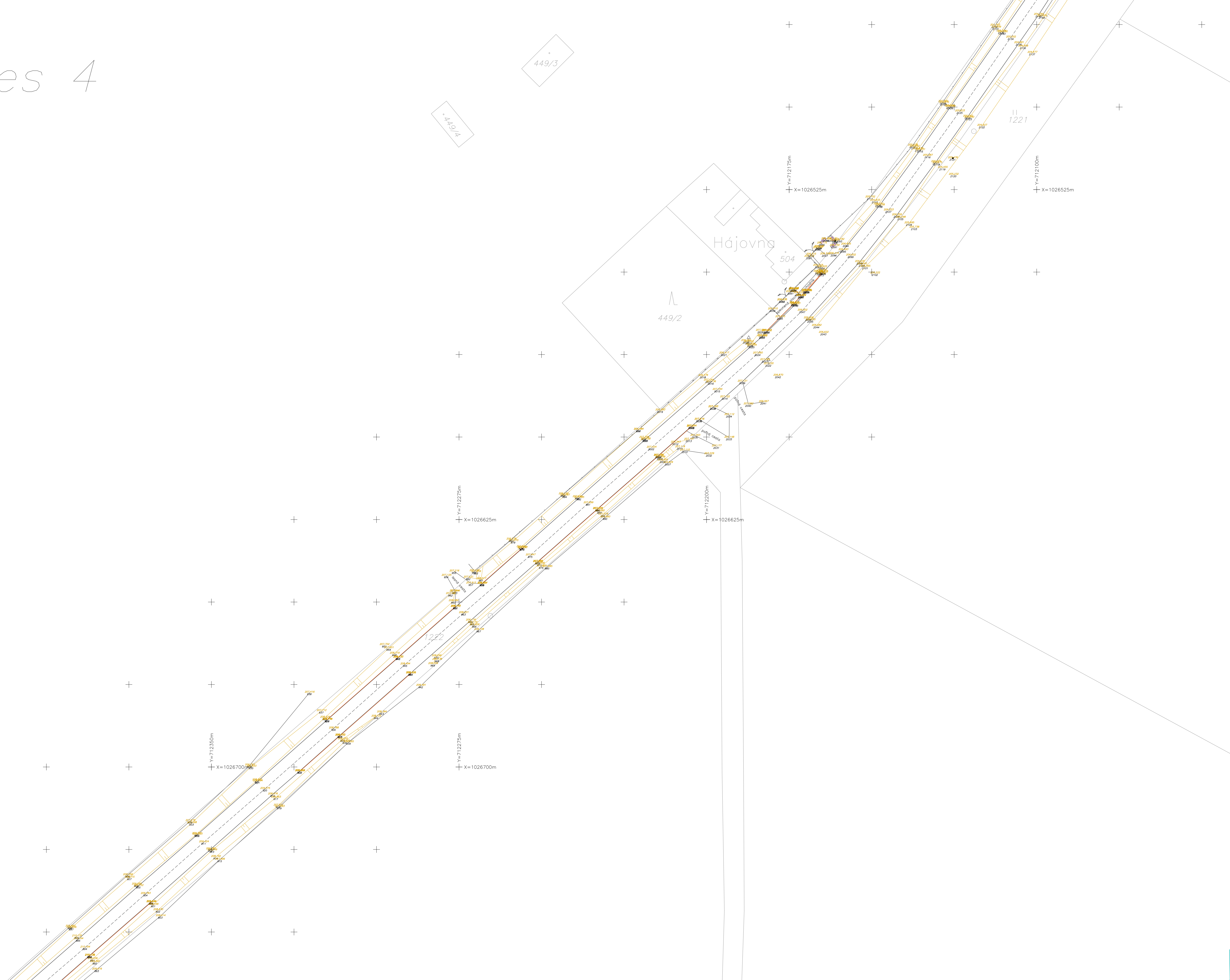

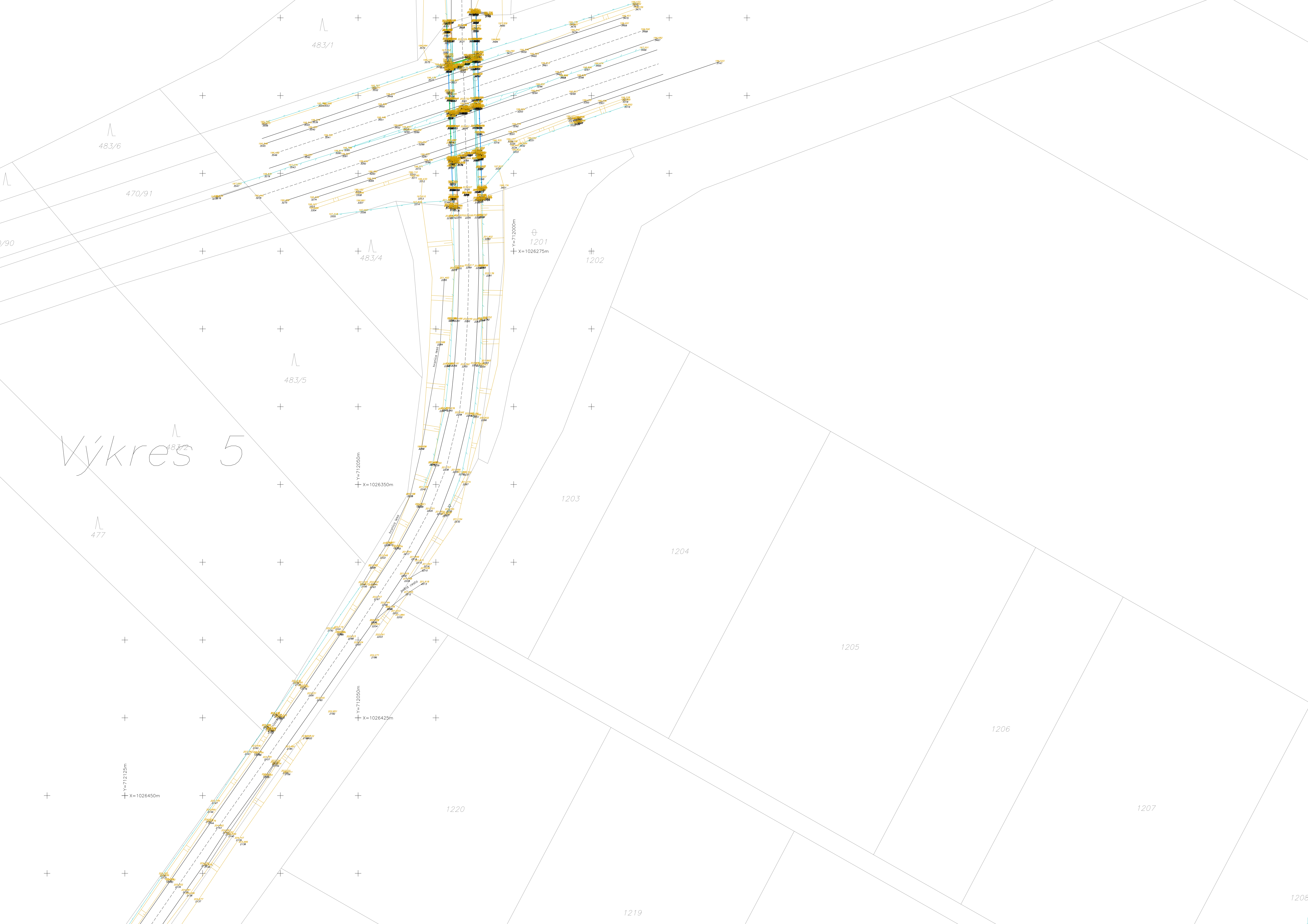

Výkres 6

Výkres 7

Výkres 8

CB	Y	X	Z
1	713352.89	1026871.60	203.78
2	713354.54	1026868.98	203.83
3	713356.67	1026866.41	203.73
4	713357.01	1026866.04	203.66
5	713359.00	1026863.75	202.84
6	713348.98	1026877.37	203.60
7	713333.93	1026868.04	203.73
8	713338.47	1026861.27	203.84
9	713340.36	1026858.19	203.84
10	713342.25	1026855.67	203.75
11	713342.48	1026855.27	203.72
12	713344.06	1026853.39	203.16
13	713333.35	1026845.50	203.46
14	713331.79	1026847.44	203.88
15	713331.38	1026848.02	203.91
16	713329.43	1026850.74	203.95
17	713327.38	1026853.43	203.90
18	713324.18	1026858.59	203.69
19	713326.99	1026858.44	203.68
20	713325.33	1026859.05	203.76
21	713326.70	1026857.12	203.72
22	713330.17	1026859.43	203.67
23	713328.81	1026861.72	203.63
24	713311.52	1026851.72	203.98
25	713314.42	1026846.24	203.99
26	713315.46	1026843.10	204.05
27	713318.22	1026840.13	204.00
28	713317.20	1026838.83	204.01
29	713320.63	1026836.36	203.88
30	713311.04	1026831.24	204.01
31	713309.31	1026833.26	204.08
32	713307.97	1026835.17	204.13
33	713306.27	1026838.36	204.10
34	713304.67	1026841.41	204.05
35	713301.77	1026847.19	204.05
36	713289.16	1026841.27	204.17
37	713290.41	1026838.62	204.18
38	713290.88	1026837.44	203.97
39	713291.31	1026836.44	204.13
40	713291.53	1026835.82	204.12
41	713300.05	1026839.72	204.08
42	713300.18	1026839.42	204.10
43	713300.16	1026841.29	203.94
44	713299.03	1026841.99	204.00
45	713298.88	1026840.76	203.89
46	713292.73	1026832.69	204.21
47	713293.50	1026829.53	204.22
48	713298.36	1026831.36	204.16
49	713298.36	1026831.36	204.16
50	713293.02	1026827.09	204.23
51	713296.00	1026822.89	204.19
52	713296.19	1026820.95	204.27
53	713286.77	1026823.35	204.29
54	713276.54	1026823.69	204.57
55	713276.55	1026823.69	204.57
56	713280.73	1026818.37	204.43
57	713272.09	1026818.65	204.66
58	713276.68	1026827.51	204.47
59	713275.66	1026830.63	204.34
60	713275.36	1026831.52	204.31
61	713274.98	1026832.60	204.14
62	713274.44	1026833.59	204.34
63	713269.96	1026832.84	204.36
64	713279.61	1026839.12	204.23
65	713260.28	1026830.98	204.47
66	713260.14	1026830.52	204.44

67	713260.27	1026829.49	204.17
68	713260.54	1026827.88	204.53
69	713260.57	1026827.50	204.56
70	713260.90	1026824.27	204.73
71	713261.45	1026820.85	204.85
72	713261.68	1026816.44	204.89
73	713266.63	1026814.42	204.77
74	713260.82	1026812.30	204.15
75	713254.08	1026813.19	204.29
76	713252.44	1026815.51	204.96
77	713252.45	1026816.46	204.99
78	713255.28	1026819.79	204.96
79	713255.29	1026819.92	204.95
80	713249.49	1026815.29	204.99
81	713249.51	1026816.52	205.07
82	713249.12	1026819.20	205.05
83	713249.15	1026819.37	205.05
84	713248.47	1026826.17	204.71
85	713248.51	1026822.86	204.89
86	713248.44	1026826.72	204.68
87	713248.46	1026828.27	204.27
88	713248.48	1026829.54	204.62
89	713248.42	1026830.13	204.62
90	713233.32	1026829.99	205.05
91	713233.28	1026829.28	205.10
92	713233.23	1026827.37	204.69
93	713233.04	1026826.10	204.87
94	713233.09	1026825.76	204.90
95	713232.22	1026828.63	205.06
96	713232.15	1026822.44	205.09
97	713231.52	1026818.86	205.34
98	713231.52	1026818.85	205.34
99	713231.89	1026818.68	205.33
100	713231.90	1026818.79	205.33
101	713236.56	1026816.61	205.33
102	713229.78	1026816.08	205.09
103	713223.43	1026817.47	205.39
104	713223.57	1026815.39	204.64
105	713223.57	1026815.38	204.63
106	713216.41	1026816.51	204.85
107	713216.41	1026816.51	204.84
108	713216.32	1026818.04	205.41
109	713215.91	1026819.76	205.55
110	713216.22	1026823.37	205.34
111	713216.33	1026826.61	205.18
112	713216.34	1026827.55	205.09
113	713216.39	1026828.69	204.87
114	713216.39	1026830.14	205.20
115	713216.29	1026830.79	205.22
116	713199.83	1026832.84	205.40
117	713199.67	1026832.41	205.30
118	713199.27	1026831.29	205.07
119	713198.78	1026829.48	205.48
120	713198.80	1026829.10	205.47
121	713198.78	1026828.98	205.48
122	713194.66	1026829.90	205.57
123	713194.64	1026830.01	205.55
124	713209.28	1026827.34	205.28
125	713209.30	1026827.46	205.28
126	713198.21	1026825.65	205.70
127	713197.54	1026822.30	205.95
129	713183.78	1026836.98	205.71
130	713183.72	1026836.71	205.73
131	713183.13	1026835.70	205.47
132	713182.61	1026834.19	205.83
133	713182.53	1026833.62	205.86
134	713181.23	1026830.48	206.03
135	713179.54	1026827.38	206.31

136	713186.38	1026823.19	206.15
137	713185.09	1026822.22	205.60
138	713185.07	1026822.20	205.60
139	713179.60	1026825.68	206.37
140	713177.30	1026824.19	205.74
141	713178.46	1026821.52	205.49
142	713172.90	1026820.07	205.52
143	713172.04	1026821.35	205.65
144	713169.76	1026822.20	206.33
145	713169.22	1026822.40	206.39
146	713172.34	1026826.03	206.41
147	713170.03	1026842.97	206.11
148	713169.59	1026842.36	206.11
149	713169.08	1026841.51	205.94
150	713168.72	1026840.43	206.14
151	713168.39	1026839.73	206.19
152	713166.43	1026836.92	206.37
153	713164.98	1026833.90	206.56
154	713164.98	1026833.90	206.56
155	713148.11	1026839.46	206.25
156	713148.42	1026839.61	206.28
157	713149.92	1026841.00	206.71
158	713150.53	1026841.54	206.74
159	713151.37	1026842.72	206.80
160	713147.78	1026845.22	206.86
161	713153.13	1026845.42	206.67
162	713155.28	1026847.86	206.52
163	713155.36	1026847.97	206.50
164	713155.70	1026848.52	206.48
165	713156.14	1026849.27	206.29
166	713156.74	1026849.97	206.34
167	713144.35	1026860.15	206.78
168	713144.17	1026859.87	206.82
169	713143.74	1026859.03	206.68
170	713143.24	1026858.29	206.87
171	713142.81	1026857.76	206.90
172	713142.73	1026857.57	206.91
173	713140.84	1026854.96	206.99
174	713138.90	1026852.80	207.06
175	713138.20	1026851.81	206.99
176	713137.39	1026850.58	206.38
177	713136.65	1026849.71	206.60
178	713128.82	1026874.76	207.29
179	713128.11	1026874.02	207.29
180	713127.50	1026873.43	207.17
181	713126.83	1026872.71	207.43
182	713126.32	1026872.08	207.50
183	713126.22	1026872.00	207.49
184	713124.43	1026869.79	207.55
185	713122.10	1026867.57	207.60
186	713121.48	1026866.70	207.55
187	713120.41	1026865.52	207.04
188	713119.48	1026864.34	207.23
189	713117.86	1026868.66	207.54
190	713115.46	1026868.80	207.44
191	713115.25	1026868.99	207.65
192	713115.71	1026869.04	207.41
193	713115.57	1026869.34	207.75
194	713116.25	1026870.07	207.80
195	713116.45	1026869.85	207.47
196	713114.15	1026869.03	207.41
197	713118.08	1026871.23	207.68
198	713118.08	1026871.23	207.68
199	713117.99	1026871.18	207.70
200	713107.87	1026880.67	208.04
201	713106.44	1026878.30	208.10
202	713106.30	1026878.23	208.08
203	713116.01	1026869.29	207.33

204	713116.60	1026870.24	207.80
205	713109.76	1026872.46	207.82
206	713103.31	1026875.59	208.21
207	713103.10	1026879.33	208.35
208	713103.50	1026880.19	208.21
209	713103.34	1026879.92	208.33
210	713110.48	1026882.04	208.01
211	713112.68	1026884.55	208.02
212	713113.86	1026885.68	208.02
213	713113.95	1026885.76	208.03
214	713116.26	1026888.08	208.06
215	713117.25	1026888.72	207.84
216	713117.25	1026888.73	207.84
217	713123.42	1026880.60	207.56
218	713122.76	1026879.77	207.57
219	713122.03	1026879.16	207.36
220	713121.30	1026878.42	207.60
221	713120.82	1026877.18	207.66
222	713120.74	1026877.04	207.69
223	713107.37	1026893.57	208.34
224	713107.46	1026893.64	208.34
225	713104.21	1026897.11	208.49
226	713104.35	1026897.38	208.54
227	713104.44	1026897.46	208.58
228	713097.92	1026903.37	208.80
229	713098.03	1026903.49	208.86
230	713097.69	1026903.17	208.74
231	713100.87	1026906.15	208.84
232	713101.73	1026907.03	208.57
233	713101.72	1026907.04	208.57
234	713095.72	1026900.37	208.66
235	713093.41	1026898.02	208.66
236	713091.70	1026895.81	208.64
237	713089.07	1026893.74	208.72
238	713088.84	1026893.49	208.76
239	713088.76	1026893.39	208.84
240	713086.40	1026891.85	209.11
241	713095.49	1026884.74	208.72
242	713094.16	1026883.39	208.68
243	713097.65	1026882.76	208.72
244	713096.46	1026881.61	208.73
245	713096.52	1026881.53	208.67
246	713097.73	1026882.66	208.63
247	713100.68	1026879.97	208.59
248	713099.32	1026878.42	208.62
249	713103.34	1026879.98	208.26
250	713103.23	1026879.89	208.33
251	713072.91	1026913.24	209.31
252	713072.91	1026913.25	209.30
253	713072.99	1026913.31	209.33
254	713075.26	1026905.29	209.23
255	713075.03	1026902.63	209.16
256	713072.92	1026903.69	209.41
257	713072.21	1026910.37	209.45
258	713072.55	1026911.50	209.44
259	713072.28	1026911.70	209.27
260	713071.86	1026911.31	208.79
261	713072.08	1026911.05	209.47
262	713072.49	1026911.72	209.40
263	713071.08	1026913.92	209.39
264	713069.78	1026913.29	208.82
265	713069.30	1026913.60	208.76
266	713077.86	1026899.68	209.03
267	713086.43	1026895.75	208.73
268	713084.94	1026894.06	209.10
269	713074.69	1026915.78	209.39
270	713076.16	1026918.59	209.42
271	713076.16	1026918.59	209.42

272	713077.57	1026920.80	209.34
273	713078.16	1026921.76	208.97
274	713078.84	1026922.82	209.57
275	713079.10	1026923.16	209.56
276	713085.41	1026918.79	209.14
277	713085.44	1026918.01	209.04
278	713086.31	1026917.47	209.08
279	713084.65	1026917.55	209.21
280	713089.78	1026910.47	209.06
281	713090.03	1026910.74	209.13
282	713090.11	1026910.83	209.16
283	713091.66	1026910.16	209.07
284	713090.79	1026914.56	209.10
285	713090.37	1026913.62	209.11
286	713091.41	1026915.42	208.93
287	713155.05	1026833.53	206.78
288	713153.69	1026833.01	206.59
289	713152.21	1026833.21	206.03
290	713150.97	1026832.65	205.99
291	713163.23	1026827.26	206.69
292	713157.00	1026815.95	206.72
293	713155.91	1026815.89	206.63
294	713162.22	1026815.59	206.56
295	713168.00	1026816.76	206.20
296	713169.91	1026817.35	206.07
297	713171.26	1026817.73	205.51
298	713172.19	1026817.72	205.35
299	713171.12	1026813.42	205.90
300	713173.26	1026814.03	205.14
301	713173.24	1026814.02	205.15
302	713171.98	1026812.46	205.73
303	713170.38	1026811.01	205.78
304	713166.44	1026808.23	206.06
305	713161.47	1026804.43	206.15
306	713160.43	1026803.64	205.98
307	713158.69	1026802.21	205.04
308	713175.31	1026792.33	204.57
309	713172.99	1026789.15	204.48
310	713174.05	1026790.32	204.35
311	713174.66	1026791.33	204.51
312	713178.45	1026795.07	204.55
313	713183.03	1026791.68	204.03
314	713180.23	1026788.32	203.94
315	713179.79	1026787.78	203.88
316	713179.25	1026786.93	203.66
317	713179.15	1026785.49	203.85
318	713072.31	1026927.94	210.00
319	713069.52	1026928.23	210.18
320	713070.58	1026925.31	209.67
321	713071.63	1026925.79	209.40
322	713061.94	1026934.40	209.87
323	713064.06	1026935.10	210.29
324	713063.54	1026934.74	210.34
325	713064.11	1026932.48	210.13
326	713061.41	1026933.56	210.07
327	713060.96	1026932.81	210.09
328	713058.51	1026930.71	210.10
329	713056.43	1026928.80	210.06
330	713055.70	1026928.05	209.95
331	713054.45	1026927.10	209.22
332	713053.85	1026926.68	209.30
333	713054.53	1026930.37	210.12
334	713054.62	1026930.47	210.12
335	713045.47	1026933.74	209.83
336	713042.79	1026931.56	210.81
337	713039.79	1026934.95	211.16
338	713037.38	1026938.75	211.20
339	713034.67	1026940.38	211.50

340	713036.92	1026943.08	210.01
341	713038.23	1026944.36	210.66
342	713038.77	1026944.90	210.75
343	713038.84	1026945.00	210.74
344	713040.98	1026947.02	210.76
345	713043.14	1026949.33	210.77
346	713043.67	1026949.88	210.75
347	713044.19	1026950.42	210.55
348	713044.86	1026951.23	211.01
349	713045.10	1026951.53	210.96
350	713024.35	1026949.73	211.94
351	713022.99	1026949.96	211.89
352	713021.90	1026951.61	211.97
353	713021.33	1026953.35	211.87
354	713024.45	1026956.68	211.25
355	713023.25	1026955.44	210.69
356	713024.32	1026957.71	211.29
357	713024.38	1026957.77	211.28
358	713022.95	1026957.25	211.19
359	713026.13	1026960.24	211.35
360	713028.25	1026962.59	211.40
361	713028.52	1026962.89	211.41
362	713029.54	1026964.17	211.41
363	713029.07	1026963.57	211.24
364	713029.78	1026964.35	211.47
365	713032.13	1026959.29	211.22
366	713032.05	1026959.22	211.22
367	713022.02	1026969.80	211.69
368	713022.13	1026969.96	211.70
369	713021.88	1026969.39	211.59
370	713021.45	1026968.94	211.73
371	713021.17	1026968.60	211.72
372	713021.11	1026968.50	211.73
373	713019.07	1026966.16	211.65
374	713017.01	1026964.03	211.58
375	713016.94	1026963.96	211.59
376	713016.29	1026963.29	211.55
377	713015.34	1026962.22	211.01
378	713013.88	1026960.98	211.69
379	713011.42	1026961.34	212.03
380	713011.42	1026961.34	212.03
381	713010.54	1026961.14	212.08
382	713008.72	1026962.61	212.14
383	713003.70	1026966.26	212.24
384	712998.90	1026969.74	212.32
385	713000.32	1026971.56	212.00
386	713001.54	1026973.02	211.55
387	713002.32	1026973.94	212.05
388	713003.03	1026974.89	212.08
389	713003.15	1026974.99	212.09
390	713005.27	1026977.24	212.18
391	713007.11	1026979.67	212.28
392	713007.18	1026979.76	212.29
393	713007.55	1026980.03	212.26
394	713007.92	1026980.57	212.06
395	713008.53	1026981.31	212.04
396	712992.22	1026993.47	212.40
397	712991.56	1026992.78	212.44
398	712990.73	1026991.95	212.80
399	712990.25	1026991.53	212.84
400	713001.34	1026983.86	212.49
401	713001.39	1026983.93	212.49
402	712988.54	1026989.00	212.76
403	712986.75	1026986.52	212.65
404	712986.66	1026986.41	212.65
405	712986.27	1026985.77	212.62
406	712985.51	1026984.50	212.19
407	712984.48	1026983.00	212.33

408	712982.52	1026981.91	212.62
409	712986.77	1026979.69	212.32
410	712980.68	1026985.23	212.45
411	712978.67	1026983.15	212.59
412	712967.85	1026993.36	212.77
413	712968.11	1026993.70	212.77
414	712968.71	1026995.14	212.60
415	712969.42	1026996.29	213.20
416	712969.85	1026997.14	213.23
417	712969.91	1026997.23	213.22
418	712971.43	1026999.84	213.32
419	712973.12	1027002.46	213.32
420	712973.55	1027003.06	213.28
421	712974.11	1027004.00	213.02
422	712974.91	1027005.19	213.31
423	712975.46	1027005.81	213.24
424	712979.46	1027002.20	213.02
425	712979.70	1027002.53	213.00
426	712985.31	1026996.42	212.83
427	712967.39	1027012.16	213.75
428	712968.11	1027010.00	213.64
429	712965.96	1027010.36	213.38
430	712965.51	1027009.11	213.07
431	712957.22	1027015.82	213.58
432	712957.26	1027015.74	213.54
433	712956.65	1027014.43	213.29
434	712956.04	1027013.53	213.65
435	712955.70	1027012.87	213.68
436	712954.15	1027010.26	213.68
437	712952.64	1027007.62	213.64
438	712952.61	1027007.53	213.63
439	712952.10	1027006.93	213.63
440	712951.50	1027006.06	213.23
441	712951.15	1027004.99	213.48
442	712948.63	1027005.98	213.69
443	712932.68	1027015.05	214.57
444	712932.77	1027015.52	214.37
445	712933.60	1027016.83	213.75
446	712933.81	1027017.53	213.77
447	712934.69	1027018.32	214.01
448	712934.77	1027018.43	214.02
449	712936.35	1027021.33	214.05
450	712937.78	1027023.66	214.04
451	712937.82	1027023.78	214.04
452	712938.12	1027024.34	213.99
453	712938.78	1027025.29	213.62
454	712938.52	1027028.04	214.35
455	712918.64	1027040.03	214.85
456	712916.85	1027038.28	214.06
457	712916.33	1027037.51	214.43
458	712917.58	1027038.51	214.30
459	712915.60	1027037.19	214.45
460	712915.54	1027037.10	214.45
461	712913.76	1027034.93	214.47
462	712912.08	1027032.14	214.43
463	712912.00	1027032.05	214.44
464	712911.64	1027031.57	214.45
465	712911.04	1027030.44	214.15
466	712912.01	1027028.15	214.78
467	712891.50	1027040.36	215.21
468	712892.52	1027041.60	214.38
469	712892.90	1027042.48	214.78
470	712893.40	1027043.25	214.76
471	712893.45	1027043.36	214.76
472	712895.18	1027045.84	214.79
473	712896.33	1027048.71	214.79
474	712896.35	1027048.83	214.78
475	712896.71	1027049.35	214.76

476	712897.26	1027050.10	214.51
477	712898.15	1027051.95	215.13
478	712879.41	1027062.95	215.38
479	712878.62	1027061.36	214.83
480	712878.03	1027060.55	215.11
481	712877.71	1027060.08	215.10
482	712877.64	1027059.97	215.09
483	712875.95	1027057.30	215.11
484	712874.43	1027054.79	215.07
485	712874.33	1027054.70	215.06
486	712873.98	1027054.15	215.06
488	712872.23	1027052.15	215.41
489	712873.41	1027053.21	214.82
490	712873.86	1027054.14	215.05
491	712874.28	1027054.71	215.06
492	712853.41	1027064.85	214.95
493	712854.44	1027066.23	215.32
494	712854.51	1027066.34	215.32
495	712856.50	1027069.01	215.38
496	712857.80	1027071.69	215.39
497	712857.99	1027072.54	215.32
498	712858.16	1027073.28	215.07
499	712860.08	1027073.51	215.60
500	712854.01	1027065.37	215.25
501	712839.24	1027072.48	215.26
502	712839.60	1027073.26	215.48
503	712839.84	1027073.78	215.51
504	712839.87	1027073.92	215.50
505	712841.87	1027076.64	215.57
506	712843.21	1027079.36	215.62
507	712843.27	1027079.48	215.62
508	712843.52	1027079.83	215.56
509	712844.01	1027080.58	215.27
510	712845.16	1027082.13	215.91
511	712829.07	1027088.30	215.18
512	712828.41	1027087.15	215.79
513	712828.16	1027086.35	215.87
514	712835.51	1027083.12	215.75
515	712835.55	1027083.22	215.75
516	712827.77	1027083.19	215.77
517	712827.02	1027079.65	215.62
518	712827.00	1027079.54	215.62
519	712814.30	1027091.06	216.09
520	712814.66	1027092.37	216.03
521	712814.89	1027093.73	215.36
522	712813.07	1027087.89	215.95
523	712799.91	1027094.42	216.24
524	712800.54	1027096.27	216.16
525	712801.32	1027097.66	215.58
526	712800.91	1027098.91	216.11
528	712812.36	1027084.63	215.72
529	712812.35	1027084.17	215.71
530	712811.82	1027082.69	215.31
531	712806.87	1027081.64	215.87
532	712818.26	1027082.75	215.64
533	712818.21	1027082.64	215.62
534	712824.69	1027080.52	215.60
535	712824.64	1027080.41	215.60
536	712824.53	1027080.05	215.60
537	712824.17	1027078.99	215.37
538	712841.12	1027071.68	215.13
539	712812.03	1027096.06	215.41
540	712799.93	1027094.39	216.19
541	712799.49	1027091.14	216.02
542	712798.94	1027087.66	215.82
543	712798.85	1027087.13	215.78
544	712798.53	1027085.74	215.39
545	712791.87	1027084.04	216.08

546	712782.68	1027089.27	215.88
547	712782.67	1027088.73	215.88
548	712782.66	1027087.12	215.41
549	712782.62	1027084.48	216.04
550	712782.48	1027092.37	216.09
551	712782.16	1027096.41	216.29
552	712766.98	1027095.50	216.33
553	712766.85	1027091.76	216.16
554	712767.12	1027088.37	215.94
555	712767.23	1027087.99	215.95
556	712767.33	1027086.66	215.41
557	712767.57	1027084.24	215.79
558	712762.24	1027087.64	215.90
559	712762.26	1027087.55	215.88
560	712750.33	1027084.74	215.94
561	712750.38	1027084.62	215.93
562	712750.50	1027084.34	215.96
563	712750.91	1027083.32	215.53
564	712751.39	1027081.47	215.80
565	712749.97	1027088.17	216.18
566	712749.27	1027091.74	216.36
567	712748.01	1027093.81	216.41
568	712740.96	1027088.78	216.39
569	712733.01	1027084.80	216.44
570	712730.61	1027089.98	216.14
571	712735.01	1027082.01	216.25
572	712737.01	1027079.15	216.02
573	712737.07	1027079.06	216.02
574	712737.21	1027078.62	216.01
575	712737.83	1027077.52	215.61
576	712739.82	1027075.24	215.75
577	712725.58	1027066.14	215.86
578	712724.39	1027067.26	215.41
579	712723.33	1027069.00	215.59
580	712722.79	1027069.78	216.07
581	712722.41	1027070.24	216.14
582	712722.35	1027070.30	216.13
583	712720.56	1027072.99	216.32
584	712718.63	1027076.22	216.54
585	712716.83	1027079.83	216.17
586	712715.12	1027082.27	215.93
587	712704.32	1027064.60	216.53
588	712703.91	1027064.87	216.49
589	712702.27	1027066.41	215.95
590	712701.68	1027066.83	215.75
591	712712.55	1027075.80	215.85
592	712706.74	1027062.06	216.39
593	712709.13	1027059.78	216.20
594	712709.21	1027059.71	216.20
595	712709.49	1027059.32	216.17
596	712711.13	1027057.91	215.54
597	712712.19	1027055.92	215.44
598	712696.10	1027047.00	216.20
599	712696.10	1027046.99	216.20
600	712696.18	1027046.91	216.19
601	712696.54	1027046.50	216.19
602	712697.51	1027045.66	215.78
603	712691.16	1027051.20	216.44
604	712693.80	1027049.33	216.39
605	712690.89	1027051.96	216.41
606	712690.57	1027054.54	215.81
607	712689.08	1027055.79	215.72
608	712677.75	1027035.75	216.40
609	712677.34	1027036.14	216.38
610	712676.19	1027037.08	215.92
611	712673.80	1027038.15	215.95
612	712680.03	1027033.01	216.32
613	712682.48	1027031.50	216.24

614	712744.21	1027098.01	216.08
615	712766.13	1027095.40	216.33
616	712760.00	1027106.18	216.28
617	712754.93	1027109.66	216.22
618	712768.41	1027106.15	216.47
619	712777.67	1027108.65	216.33
620	712778.21	1027111.14	216.29
621	712779.22	1027112.57	215.85
622	712780.24	1027112.63	215.92
623	712784.08	1027105.11	216.20
624	712785.10	1027105.97	215.84
625	712786.40	1027106.95	215.70
626	712776.58	1027115.32	216.34
627	712776.44	1027115.54	216.48
628	712776.48	1027115.54	216.48
629	712777.67	1027115.71	216.06
630	712778.67	1027116.01	216.01
631	712778.55	1027116.26	216.42
632	712778.85	1027116.54	216.11
633	712781.37	1027119.17	216.03
634	712783.62	1027119.47	216.04
635	712783.67	1027123.76	216.11
636	712783.68	1027122.44	216.07
637	712773.86	1027115.62	216.39
638	712772.55	1027119.84	216.44
639	712772.55	1027119.84	216.44
640	712775.14	1027122.69	216.55
641	712775.54	1027122.70	216.54
642	712775.28	1027122.95	216.24
643	712773.18	1027122.83	216.46
644	712771.86	1027126.56	216.57
645	712772.61	1027126.86	216.56
646	712773.68	1027127.02	216.40
647	712774.94	1027127.45	216.39
648	712768.26	1027127.11	216.68
649	712764.57	1027127.87	216.69
650	712761.77	1027129.94	216.59
651	712765.59	1027138.26	216.73
652	712769.59	1027143.60	217.00
653	712769.31	1027143.75	216.95
654	712767.93	1027144.51	216.53
655	712767.30	1027145.10	216.74
656	712772.35	1027141.68	217.00
657	712775.49	1027140.38	216.92
658	712776.13	1027140.17	216.87
659	712777.40	1027139.32	216.56
660	712778.24	1027139.15	216.64
661	712773.18	1027129.38	216.60
662	712765.57	1027138.27	216.73
663	712764.46	1027127.41	216.68
664	712764.46	1027127.42	216.68
665	712760.91	1027121.35	216.42
666	712759.38	1027114.60	216.29
667	712761.91	1027110.35	216.32
668	712761.91	1027110.36	216.32
669	712751.56	1027118.11	216.44
670	712753.39	1027122.66	216.45
671	712755.03	1027125.63	216.47
672	712759.83	1027125.07	216.51
673	712698.41	1027043.11	215.75
674	712682.27	1027031.29	216.25
675	712683.13	1027030.71	216.17
676	712683.66	1027029.95	215.77
677	712684.09	1027027.42	215.85
678	712666.56	1027012.00	216.17
679	712666.88	1027011.71	216.13
680	712668.11	1027011.04	215.80
681	712669.65	1027009.69	215.75

682	712664.76	1027014.30	216.20
683	712662.21	1027016.46	216.17
684	712661.64	1027016.87	216.12
685	712660.64	1027018.09	215.69
686	712659.43	1027019.48	215.69
687	712648.51	1026999.14	215.99
688	712648.01	1026999.53	215.97
689	712647.07	1027000.24	215.70
690	712646.26	1027002.17	215.94
691	712651.01	1026997.74	216.03
692	712653.75	1026996.00	216.01
693	712654.17	1026995.72	215.98
694	712655.00	1026995.06	215.68
695	712658.90	1026996.11	215.86
696	712658.09	1026998.39	215.94
697	712640.38	1026979.37	215.84
698	712640.49	1026979.27	215.84
699	712640.77	1026979.05	215.82
700	712641.93	1026978.29	215.57
701	712643.76	1026976.94	215.50
702	712649.32	1026990.40	215.93
703	712649.38	1026990.36	215.93
704	712638.01	1026981.24	215.85
705	712635.65	1026983.03	215.79
706	712635.21	1026983.40	215.78
707	712634.36	1026984.16	215.50
708	712627.66	1026973.11	215.65
709	712627.59	1026973.17	215.65
710	712624.63	1026970.70	215.56
711	712625.16	1026970.33	215.59
712	712625.24	1026970.25	215.58
713	712627.68	1026968.46	215.71
714	712629.98	1026966.42	215.73
715	712630.28	1026966.23	215.75
716	712631.26	1026965.38	215.47
717	712632.85	1026963.78	215.59
718	712636.93	1026966.17	215.47
719	712626.32	1026976.34	215.48
720	712626.76	1026975.01	215.28
721	712615.29	1026958.81	215.39
722	712615.22	1026958.88	215.38
723	712614.53	1026959.31	215.37
724	712613.74	1026959.75	215.13
725	712612.96	1026960.28	215.21
726	712611.67	1026962.11	215.21
727	712617.10	1026956.48	215.56
728	712619.12	1026954.15	215.60
729	712617.84	1026952.08	215.58
730	712618.55	1026951.16	215.37
731	712616.71	1026951.57	215.57
732	712617.81	1026950.42	215.36
733	712621.28	1026947.55	215.20
734	712619.08	1026946.31	215.25
735	712615.71	1026948.44	215.27
737	712614.41	1026949.38	215.51
738	712626.50	1026959.17	215.60
739	712616.90	1026942.56	214.92
740	712617.68	1026942.49	214.68
741	712612.03	1026939.30	214.82
742	712609.28	1026941.98	214.91
743	712608.40	1026942.89	215.32
744	712608.00	1026943.42	215.39
745	712605.99	1026945.75	215.34
746	712603.83	1026947.63	215.22
747	712603.69	1026947.64	215.22
748	712603.34	1026948.06	215.25
749	712602.56	1026948.69	214.85
750	712601.58	1026949.43	215.04

751	712601.87	1026952.02	214.96
752	712582.33	1026934.61	214.45
753	712583.56	1026933.29	214.56
754	712588.23	1026937.51	214.67
755	712585.43	1026932.67	214.96
756	712585.84	1026931.98	215.00
757	712585.91	1026931.89	215.02
758	712587.88	1026929.70	215.13
759	712590.14	1026927.55	215.07
760	712590.19	1026927.45	215.07
761	712590.49	1026927.24	215.07
762	712591.68	1026926.13	214.61
763	712594.41	1026923.58	214.51
764	712603.48	1026939.27	215.29
765	712603.54	1026939.21	215.30
766	712574.57	1026911.13	214.35
767	712573.51	1026912.35	214.82
768	712573.31	1026912.61	214.81
769	712573.26	1026912.71	214.81
770	712571.38	1026915.13	214.86
771	712569.10	1026917.13	214.79
772	712569.02	1026917.20	214.79
773	712568.48	1026917.86	214.75
774	712567.34	1026918.98	214.21
775	712566.04	1026919.51	214.15
776	712548.64	1026904.36	214.21
777	712549.84	1026902.85	214.19
778	712550.57	1026901.91	214.47
779	712551.05	1026901.43	214.46
780	712551.13	1026901.36	214.47
781	712553.07	1026898.93	214.51
782	712555.15	1026896.83	214.49
783	712555.23	1026896.74	214.49
784	712555.67	1026896.39	214.45
785	712556.71	1026895.42	214.00
786	712557.50	1026893.89	213.94
787	712536.33	1026880.27	214.08
788	712536.44	1026880.16	214.09
789	712536.77	1026879.97	214.07
790	712537.92	1026879.22	213.55
791	712539.13	1026878.32	213.47
792	712534.58	1026882.74	214.11
793	712532.54	1026884.97	214.07
794	712532.49	1026885.10	214.07
795	712531.95	1026885.87	214.01
796	712530.58	1026886.93	213.45
797	712526.94	1026885.50	213.40
798	712520.35	1026874.42	213.83
799	712520.43	1026874.32	213.83
800	712515.26	1026869.57	213.78
801	712514.34	1026870.40	213.62
802	712513.47	1026871.21	213.29
803	712512.59	1026872.75	213.11
804	712516.68	1026866.99	213.79
805	712518.50	1026864.54	213.73
806	712518.58	1026864.48	213.69
807	712517.39	1026863.45	213.67
808	712517.33	1026863.52	213.71
809	712519.33	1026864.51	213.70
810	712521.00	1026862.82	212.96
811	712521.46	1026862.82	212.88
812	712505.12	1026847.42	212.43
813	712505.13	1026847.43	212.43
814	712502.45	1026849.22	213.25
815	712501.81	1026849.81	213.24
816	712501.73	1026849.89	213.28
817	712499.74	1026851.88	213.34
818	712497.32	1026854.07	213.29

819	712496.63	1026854.94	213.20
820	712495.73	1026855.71	212.95
821	712492.57	1026855.43	212.90
822	712481.87	1026832.50	212.75
823	712481.96	1026832.37	212.69
824	712482.74	1026831.17	212.58
825	712483.96	1026830.20	212.20
826	712485.36	1026829.42	212.06
827	712482.00	1026832.42	212.69
828	712482.00	1026832.43	212.69
829	712485.36	1026831.70	212.29
830	712487.63	1026829.55	212.03
831	712489.24	1026831.08	212.03
832	712487.63	1026832.57	212.25
833	712485.75	1026834.51	212.78
834	712485.32	1026835.35	212.78
835	712485.32	1026835.36	212.78
836	712483.14	1026832.25	212.72
837	712477.40	1026832.29	212.72
838	712475.28	1026834.59	212.67
839	712474.58	1026835.44	212.55
840	712473.77	1026836.48	212.31
841	712474.45	1026839.69	212.33
842	712470.53	1026831.42	212.55
843	712459.82	1026822.16	212.23
844	712458.95	1026823.24	212.15
845	712457.29	1026824.51	212.04
846	712459.11	1026821.08	212.22
847	712459.45	1026820.66	212.23
848	712461.48	1026818.38	212.32
849	712463.49	1026816.31	212.26
850	712463.56	1026816.21	212.21
851	712464.45	1026815.37	212.16
852	712467.30	1026815.20	211.41
853	712467.89	1026814.53	211.43
854	712449.29	1026812.87	211.95
855	712442.76	1026810.43	211.47
856	712440.71	1026806.87	211.31
857	712441.45	1026805.95	211.68
858	712441.91	1026805.42	211.74
859	712443.78	1026803.00	211.74
860	712445.83	1026800.79	211.73
861	712445.94	1026800.72	211.74
862	712446.77	1026800.05	211.70
863	712453.04	1026802.42	210.97
864	712453.03	1026802.42	210.97
865	712438.56	1026802.45	211.63
866	712438.48	1026802.54	211.65
867	712425.35	1026790.83	211.25
868	712425.30	1026790.95	211.23
869	712424.64	1026791.79	211.19
870	712423.46	1026792.74	210.76
871	712427.43	1026788.68	211.29
872	712429.41	1026786.35	211.25
873	712429.50	1026786.28	211.25
874	712430.42	1026785.53	211.18
875	712431.54	1026783.42	210.32
876	712431.75	1026783.21	210.21
877	712414.80	1026773.49	210.81
878	712414.86	1026773.40	210.82
879	712409.62	1026768.98	210.66
880	712410.21	1026768.34	210.63
881	712411.73	1026766.37	209.97
882	712412.17	1026765.56	209.77
883	712407.54	1026771.25	210.69
884	712405.55	1026773.49	210.63
885	712405.47	1026773.60	210.60
886	712405.13	1026774.15	210.61

887	712404.15	1026775.30	210.29
888	712403.75	1026777.04	210.35
889	712386.87	1026757.10	210.13
890	712386.81	1026757.19	210.14
891	712386.00	1026758.18	210.04
892	712385.26	1026759.07	209.66
893	712384.68	1026761.35	209.62
894	712388.26	1026754.68	210.16
895	712390.33	1026752.14	210.16
896	712390.75	1026751.29	210.13
897	712392.40	1026748.74	208.93
898	712392.74	1026748.34	208.86
899	712368.25	1026740.86	209.63
900	712368.17	1026740.94	209.65
901	712367.58	1026741.73	209.55
902	712366.14	1026743.34	208.63
903	712365.41	1026745.17	208.61
904	712369.95	1026738.42	209.78
905	712372.10	1026736.02	209.72
906	712372.65	1026735.58	209.68
907	712374.81	1026733.50	208.32
908	712375.31	1026732.74	208.06
909	712354.23	1026720.43	209.32
910	712354.43	1026720.26	209.33
911	712352.30	1026722.78	209.42
912	712350.17	1026724.89	209.28
913	712349.77	1026725.22	209.25
914	712348.66	1026727.22	208.19
915	712347.42	1026728.07	207.90
916	712331.41	1026708.27	208.98
917	712330.46	1026709.23	208.86
918	712329.71	1026711.65	207.82
919	712329.35	1026712.05	207.68
920	712333.75	1026706.60	209.07
921	712335.99	1026704.31	208.99
922	712336.16	1026703.99	208.98
923	712314.87	1026685.67	208.74
924	712314.93	1026685.60	208.75
925	712315.60	1026685.01	208.62
926	712312.94	1026688.26	208.79
927	712311.07	1026690.38	208.73
928	712310.97	1026690.47	208.74
929	712310.22	1026691.58	208.66
930	712309.54	1026692.21	208.43
931	712323.23	1026701.20	208.86
932	712323.16	1026701.25	208.86
933	712355.96	1026716.97	207.50
934	712356.39	1026716.34	207.28
935	712337.90	1026699.88	206.83
936	712338.40	1026699.47	206.76
937	712316.66	1026682.99	207.71
938	712320.26	1026677.43	207.42
939	712308.40	1026692.45	208.26
940	712289.62	1026671.51	208.42
941	712289.55	1026671.59	208.44
942	712286.51	1026675.34	208.48
943	712298.40	1026683.40	208.38
944	712300.08	1026684.69	208.13
945	712291.29	1026668.86	208.49
946	712293.40	1026666.81	208.43
947	712293.48	1026666.75	208.44
948	712294.51	1026665.60	208.32
949	712296.25	1026663.97	207.60
950	712297.59	1026662.98	207.70
951	712275.99	1026651.44	208.17
952	712276.07	1026651.35	208.17
953	712276.12	1026646.82	207.84
954	712278.80	1026642.00	207.13

955	712276.43	1026640.70	207.22
957	712271.35	1026644.33	207.91
958	712268.02	1026644.36	208.05
959	712267.93	1026644.43	208.06
960	712276.67	1026649.68	208.08
961	712276.39	1026646.72	207.81
962	712277.53	1026647.53	207.50
963	712273.57	1026653.32	208.20
964	712271.44	1026655.58	208.18
965	712270.95	1026656.29	208.17
966	712270.32	1026656.98	207.93
967	712268.97	1026658.40	208.11
968	712281.65	1026667.46	208.14
969	712282.87	1026668.75	208.31
970	712281.81	1026666.38	208.30
971	712251.15	1026637.76	207.90
972	712251.07	1026637.84	207.90
973	712250.60	1026638.37	207.86
974	712250.04	1026639.16	207.60
975	712253.35	1026635.82	207.95
976	712255.75	1026633.67	207.90
977	712255.83	1026633.58	207.91
978	712256.12	1026633.32	207.94
979	712258.54	1026631.49	207.07
980	712259.18	1026631.01	206.88
981	712268.30	1026643.01	208.02
982	712272.15	1026642.57	207.63
983	712269.83	1026640.87	207.26
984	712270.34	1026640.58	207.10
985	712248.22	1026639.34	207.69
986	712233.01	1026621.72	207.62
987	712232.94	1026621.80	207.62
988	712232.38	1026622.48	207.58
989	712231.34	1026623.47	207.03
990	712230.70	1026624.31	206.86
991	712235.83	1026620.02	207.70
992	712238.59	1026618.40	207.69
993	712239.12	1026618.15	207.65
994	712242.92	1026617.68	206.59
995	712243.36	1026617.30	206.53
996	712220.61	1026597.74	206.46
997	712220.60	1026597.74	206.45
998	712218.92	1026600.19	207.40
999	712218.51	1026600.69	207.43
2001	712218.52	1026600.69	207.43
2002	712216.69	1026603.19	207.42
2003	712214.58	1026605.57	207.38
2004	712214.51	1026605.66	207.40
2005	712214.04	1026606.17	207.35
2006	712213.23	1026607.07	206.86
2007	712211.69	1026607.81	206.93
2008	712204.59	1026596.72	207.25
2009	712204.51	1026596.80	207.21
2010	712206.59	1026604.07	207.11
2011	712208.05	1026603.05	207.12
2012	712209.37	1026601.65	207.34
2013	712205.35	1026600.75	207.17
2014	712194.46	1026587.90	207.12
2015	712196.73	1026585.66	207.16
2016	712198.67	1026583.33	207.14
2017	712199.39	1026582.84	207.14
2018	712201.06	1026581.41	206.48
2019	712214.04	1026591.88	206.38
2021	712194.70	1026574.64	206.42
2022	712181.24	1026577.89	207.03
2023	712182.34	1026576.64	207.10
2024	712184.49	1026574.65	207.06
2025	712186.32	1026572.29	207.03

2026	712186.71	1026571.94	207.06
2027	712187.25	1026571.17	206.84
2028	712188.05	1026570.85	206.59
2029	712183.62	1026567.77	207.05
2030	712203.46	1026599.61	207.26
2031	712196.98	1026602.79	207.18
2032	712199.22	1026605.14	207.23
2033	712193.15	1026600.18	207.15
2034	712193.13	1026593.29	207.11
2035	712202.20	1026594.70	207.22
2036	712202.20	1026594.70	207.22
2037	712198.03	1026590.92	207.16
2038	712198.03	1026590.92	207.16
2039	712189.13	1026583.17	207.12
2040	712187.33	1026590.06	207.06
2041	712182.72	1026589.35	206.97
2042	712178.31	1026581.38	206.87
2043	712164.56	1026568.38	206.62
2044	712166.68	1026566.27	206.68
2045	712168.51	1026564.54	206.95
2046	712169.10	1026563.98	206.91
2047	712170.98	1026561.65	206.90
2048	712173.06	1026559.74	206.86
2049	712173.38	1026559.46	206.94
2050	712173.47	1026559.37	206.97
2051	712183.05	1026569.45	206.96
2052	712183.17	1026569.27	207.02
2053	712181.75	1026567.88	207.01
2054	712181.82	1026567.79	207.05
2055	712177.72	1026563.63	207.01
2059	712177.16	1026558.52	206.94
2060	712177.16	1026558.52	206.94
2061	712174.50	1026556.01	206.96
2062	712173.73	1026555.26	206.97
2064	712173.62	1026555.15	206.98
2065	712173.55	1026555.08	206.99
2066	712171.41	1026557.19	206.93
2067	712171.34	1026557.12	206.92
2068	712172.17	1026556.35	206.93
2069	712169.73	1026555.67	206.87
2070	712169.86	1026555.55	206.90
2071	712169.58	1026555.79	206.79
2072	712166.17	1026549.83	206.72
2073	712165.30	1026550.52	206.78
2074	712164.81	1026550.00	206.78
2075	712164.69	1026550.09	206.70
2076	712165.01	1026548.49	206.62
2077	712165.04	1026549.49	206.70
2078	712165.66	1026550.14	206.75
2079	712168.34	1026544.70	206.32
2080	712166.35	1026542.73	206.25
2081	712168.91	1026545.32	206.31
2083	712166.26	1026548.06	206.52
2084	712165.96	1026542.33	206.24
2085	712165.96	1026542.33	206.24
2086	712165.05	1026541.31	206.18
2088	712163.76	1026540.04	206.17
2089	712163.76	1026540.04	206.17
2090	712161.98	1026540.05	206.14
2091	712161.23	1026541.99	206.25
2092	712161.05	1026540.52	206.20
2093	712159.78	1026540.21	206.18
2094	712157.79	1026541.63	206.44
2095	712158.59	1026543.31	206.49
2096	712161.45	1026544.48	206.41
2097	712164.11	1026544.58	206.30
2098	712153.59	1026546.89	206.63
2099	712156.29	1026544.95	206.60

2100	712152.93	1026547.61	206.64
2101	712151.89	1026548.36	206.37
2103	712137.09	1026536.49	205.74
2104	712138.61	1026535.20	205.69
2105	712141.20	1026533.49	206.30
2106	712142.37	1026532.74	206.36
2107	712144.87	1026531.27	206.33
2108	712147.53	1026529.75	206.26
2109	712147.92	1026529.40	206.24
2110	712148.99	1026528.36	205.83
2111	712150.44	1026527.33	205.75
2112	712137.56	1026511.60	205.44
2113	712136.99	1026511.99	205.48
2114	712135.89	1026512.67	205.84
2115	712135.25	1026513.00	205.93
2116	712132.99	1026514.73	205.99
2117	712130.51	1026516.61	205.97
2118	712130.14	1026516.94	205.97
2119	712128.48	1026518.39	205.46
2120	712125.16	1026520.47	205.23
2121	712125.42	1026515.46	205.48
2122	712116.55	1026505.62	204.93
2123	712120.44	1026503.19	205.59
2124	712120.85	1026502.86	205.59
2125	712123.28	1026501.27	205.63
2126	712126.09	1026499.88	205.60
2127	712126.43	1026499.70	205.61
2128	712128.10	1026498.72	204.97
2129	712128.36	1026498.36	204.99
2130	712112.62	1026475.25	204.39
2131	712112.30	1026475.87	204.50
2132	712110.72	1026477.05	205.00
2133	712110.28	1026477.28	204.98
2134	712107.82	1026478.87	205.00
2135	712105.36	1026480.56	204.98
2136	712104.11	1026481.63	204.96
2137	712101.33	1026483.52	204.48
2138	712086.94	1026465.14	203.99
2139	712088.25	1026463.82	204.15
2140	712090.71	1026462.59	204.50
2141	712091.67	1026462.02	204.55
2142	712092.51	1026461.39	204.48
2143	712094.72	1026459.87	204.46
2144	712097.21	1026458.36	204.48
2145	712097.98	1026457.92	204.40
2146	712097.38	1026454.77	203.97
2147	712096.01	1026451.92	203.78
2148	712099.39	1026471.99	204.79
2149	712098.42	1026472.44	204.82
2150	712076.48	1026439.00	203.72
2151	712079.00	1026443.62	203.96
2152	712079.53	1026443.37	203.91
2153	712076.72	1026439.44	203.76
2154	712076.21	1026439.97	203.82
2155	712073.26	1026442.26	203.53
2156	712072.61	1026442.67	203.51
2157	712079.19	1026437.85	203.78
2158	712081.93	1026436.43	203.73
2159	712082.42	1026436.23	203.78
2160	712082.88	1026434.23	203.41
2161	712085.45	1026436.15	203.38
2162	712078.00	1026428.69	203.44
2163	712077.89	1026428.56	203.54
2164	712079.51	1026427.59	203.28
2165	712079.49	1026427.54	203.54
2166	712078.80	1026428.14	203.19
2167	712077.97	1026428.67	203.54
2168	712077.98	1026428.68	203.54

2169	712078.00	1026429.28	203.48
2170	712075.20	1026424.84	203.40
2171	712075.19	1026424.85	203.40
2172	712074.38	1026424.42	203.34
2173	712075.98	1026424.20	203.11
2174	712076.66	1026423.68	203.14
2175	712076.67	1026423.75	203.44
2176	712067.21	1026415.22	202.96
2177	712067.75	1026414.79	202.99
2178	712069.28	1026413.90	202.66
2179	712069.92	1026413.36	202.64
2180	712062.29	1026418.83	203.00
2181	712064.94	1026417.34	203.03
2182	712058.23	1026423.17	202.85
2183	712065.64	1026431.11	203.12
2184	712066.75	1026431.07	203.22
2185	712071.94	1026434.48	203.49
2186	712044.75	1026405.11	202.27
2187	712049.91	1026400.96	202.50
2188	712052.27	1026399.07	202.52
2189	712055.47	1026397.77	202.48
2190	712055.82	1026397.58	202.51
2191	712056.31	1026396.02	202.11
2192	712058.80	1026396.45	202.05
2193	712045.23	1026382.47	202.01
2194	712044.91	1026381.58	202.00
2195	712047.96	1026382.30	201.42
2196	712048.44	1026381.61	201.32
2197	712043.91	1026386.38	202.16
2198	712041.36	1026388.21	202.18
2199	712039.73	1026389.54	202.17
2200	712039.75	1026389.55	202.17
2201	712037.91	1026390.88	201.83
2202	712036.58	1026392.16	201.88
2203	712042.95	1026398.46	202.09
2204	712044.59	1026395.09	202.35
2205	712044.81	1026393.82	202.32
2206	712044.82	1026393.82	202.32
2207	712035.15	1026378.87	201.96
2209	712034.17	1026380.53	201.77
2210	712028.47	1026377.15	201.46
2212	712033.81	1026384.80	201.51
2213	712028.72	1026381.47	201.62
2214	712031.93	1026373.51	201.90
2215	712030.34	1026374.64	201.87
2216	712027.89	1026375.81	201.47
2217	712034.37	1026371.89	201.85
2218	712037.16	1026370.16	201.63
2219	712037.64	1026369.87	201.62
2220	712045.24	1026376.23	201.07
2221	712045.25	1026376.20	201.10
2222	712041.96	1026373.02	201.05
2223	712039.54	1026368.88	200.86
2224	712040.64	1026369.05	200.80
2225	712033.17	1026353.26	200.19
2226	712033.17	1026353.28	200.19
2227	712030.25	1026356.51	201.56
2228	712029.83	1026356.70	201.52
2229	712026.87	1026357.98	201.70
2230	712023.70	1026358.99	201.85
2231	712021.86	1026359.67	201.81
2232	712018.04	1026361.41	201.15
2233	712020.62	1026358.18	201.76
2234	712021.41	1026359.23	201.81
2235	712018.57	1026345.49	201.89
2236	712016.64	1026346.21	201.95
2237	712015.11	1026346.34	201.72
2238	712021.71	1026344.76	201.76

2239	712024.72	1026343.36	201.59
2240	712025.74	1026343.09	201.46
2241	712026.07	1026343.12	201.40
2242	712029.01	1026351.04	201.16
2243	712029.54	1026338.05	199.66
2244	712029.54	1026338.05	199.66
2245	712020.47	1026325.75	201.88
2246	712022.06	1026325.66	201.73
2247	712022.82	1026325.89	201.67
2248	712017.46	1026327.07	202.04
2249	712014.23	1026327.40	202.16
2250	712012.80	1026327.44	202.19
2251	712011.92	1026327.80	202.00
2252	712012.40	1026311.19	202.47
2253	712010.99	1026311.31	202.46
2254	712009.87	1026311.66	202.26
2255	712015.66	1026311.58	202.36
2256	712019.00	1026311.33	202.16
2257	712020.45	1026311.34	201.99
2258	712021.36	1026311.46	201.82
2259	712019.97	1026296.78	202.10
2260	712019.65	1026296.88	202.19
2261	712017.99	1026296.93	202.49
2262	712014.82	1026297.00	202.65
2263	712011.64	1026297.16	202.74
2264	712010.09	1026296.76	202.63
2265	712010.08	1026296.77	202.62
2266	712009.72	1026279.82	202.81
2267	712009.87	1026279.83	202.81
2268	712011.16	1026279.91	202.92
2269	712014.36	1026279.76	202.92
2270	712017.51	1026280.05	202.81
2271	712019.02	1026280.59	202.63
2272	712019.00	1026280.58	202.63
2273	712020.48	1026263.90	202.59
2274	712019.41	1026263.84	202.75
2275	712017.56	1026263.71	202.91
2276	712014.62	1026263.75	203.01
2277	712011.56	1026263.68	202.97
2278	712010.42	1026263.70	202.81
2279	712010.04	1026263.53	202.71
2280	712008.26	1026270.60	201.90
2281	712007.83	1026282.36	202.14
2282	712008.55	1026296.50	202.05
2283	712008.88	1026310.42	201.86
2284	712023.57	1026304.52	200.59
2285	712022.27	1026283.79	201.48
2286	712009.47	1026328.81	200.60
2287	712015.35	1026349.45	201.27
2288	712010.29	1026192.50	200.95
2289	712010.77	1026192.50	201.31
2290	712012.32	1026192.51	201.78
2291	712013.63	1026192.35	201.82
2292	712016.70	1026192.25	201.83
2293	712020.06	1026192.46	201.83
2294	712021.63	1026193.17	201.79
2295	712022.07	1026192.92	201.73
2296	712025.20	1026177.50	199.76
2297	712023.20	1026176.51	200.96
2298	712021.47	1026176.38	201.22
2299	712019.89	1026176.48	201.27
2300	712016.76	1026176.83	201.22
2301	712013.17	1026176.74	201.11
2302	712012.27	1026176.28	200.99
2303	712010.73	1026176.07	200.64
2304	712009.95	1026176.28	200.38
2305	712008.59	1026158.24	199.75
2306	712008.26	1026158.33	199.61

2307	712002.83	1026163.43	197.04
2308	712010.40	1026157.99	200.10
2309	712011.47	1026157.64	200.14
2310	712014.59	1026156.55	200.29
2311	712017.86	1026155.76	200.31
2312	712019.37	1026155.41	200.13
2313	712019.79	1026155.62	199.99
2314	712021.72	1026154.21	198.97
2315	712025.01	1026150.79	196.65
2316	712021.78	1026136.89	196.43
2317	712018.58	1026132.34	197.29
2318	712015.27	1026136.28	199.14
2319	712015.21	1026136.29	199.11
2320	712013.76	1026136.56	199.22
2321	712010.84	1026138.25	199.23
2322	712007.62	1026138.90	199.05
2323	712006.41	1026139.44	198.93
2324	712006.28	1026139.50	198.87
2325	712003.96	1026140.29	197.06
2326	712001.52	1026141.32	196.43
2327	712002.67	1026123.47	198.07
2328	712001.25	1026123.44	197.93
2329	712001.36	1026123.43	197.95
2330	711999.06	1026124.87	196.98
2331	711997.30	1026124.50	196.22
2332	712005.66	1026121.84	198.21
2333	712008.60	1026120.77	198.31
2334	712010.06	1026120.28	198.34
2335	712011.47	1026119.51	198.09
2336	712017.02	1026120.12	196.26
2337	712004.21	1026105.80	197.47
2338	712003.94	1026105.93	197.54
2339	712004.82	1026101.94	196.19
2340	712002.36	1026106.02	197.53
2341	711999.82	1026107.68	197.43
2342	711996.73	1026109.22	197.25
2343	711995.50	1026109.56	197.19
2344	711994.30	1026111.46	196.95
2345	711994.14	1026111.58	196.88
2346	711992.70	1026112.74	196.04
2347	711988.35	1026094.34	196.59
2348	711991.63	1026102.32	196.69
2349	711984.97	1026098.23	195.77
2350	711991.19	1026092.84	196.71
2351	711993.83	1026090.87	196.70
2352	711995.16	1026089.98	196.62
2353	711995.16	1026089.98	196.61
2354	711996.61	1026089.02	196.06
2355	711987.93	1026075.76	195.68
2356	711986.41	1026077.33	196.29
2357	711986.41	1026077.33	196.29
2358	711985.30	1026077.89	196.35
2359	711982.61	1026079.59	196.39
2360	711979.85	1026081.41	196.35
2361	711976.12	1026086.17	195.85
2362	711989.70	1026103.20	196.07
2363	711991.40	1026101.41	196.70
2364	711978.02	1026080.37	196.26
2365	711985.11	1026075.06	196.32
2366	711984.12	1026074.22	196.22
2367	711981.41	1026072.26	196.24
2369	711982.75	1026069.19	195.83
2370	711984.82	1026067.18	195.80
2371	711982.32	1026064.72	195.70
2372	711979.95	1026065.96	195.81
2373	711977.26	1026066.62	196.21
2374	711977.26	1026066.62	196.21
2375	711982.80	1026069.16	195.84

2376	711963.73	1026070.68	196.01
2377	711965.54	1026069.41	195.80
2378	711968.78	1026066.98	196.20
2379	711974.09	1026062.87	196.19
2380	711977.75	1026061.02	195.76
2381	711976.36	1026060.73	195.63
2382	711971.94	1026065.50	196.22
2383	711982.39	1026072.30	196.19
2384	711959.05	1026045.03	196.03
2385	711961.47	1026043.26	195.55
2386	711958.93	1026039.44	195.73
2387	711968.65	1026049.89	195.63
2389	711956.70	1026047.36	196.13
2390	711954.09	1026049.71	196.12
2391	711952.28	1026053.04	195.46
2392	711948.82	1026051.83	195.81
2393	711941.88	1026024.83	195.97
2394	711939.45	1026027.04	196.05
2395	711936.89	1026029.17	196.02
2396	711935.24	1026033.69	195.56
2397	711933.59	1026033.33	195.64
2398	711924.32	1026003.70	195.96
2399	711921.69	1026005.99	196.04
2400	711919.33	1026008.20	195.99
2401	711943.84	1026023.01	195.39
2402	711946.01	1026021.28	195.61
2403	711925.39	1026001.53	195.61
2404	711927.36	1025999.01	195.69
2405	711922.70	1026001.82	195.97
2406	711920.21	1026004.25	196.04
2407	711917.68	1026006.31	195.97
2408	711914.79	1026008.47	195.47
2409	711913.54	1026009.97	195.77
2410	711913.46	1025989.24	195.81
2411	711908.70	1025978.85	195.68
2412	711910.02	1025978.09	195.62
2413	711907.68	1025979.85	195.46
2414	711905.37	1025981.45	195.90
2415	711905.82	1025981.16	195.88
2416	711902.87	1025983.56	195.97
2417	711900.47	1025985.86	195.91
2418	711896.40	1025988.61	195.90
2419	711900.37	1025985.72	195.90
2421	711893.76	1025982.57	195.85
2422	711889.74	1025984.57	195.95
2423	711880.65	1025966.84	195.86
2424	711877.80	1025969.12	195.66
2425	711882.91	1025964.87	195.91
2426	711885.29	1025962.75	195.88
2427	711888.03	1025960.88	195.82
2428	711888.95	1025960.15	195.71
2429	711889.71	1025959.45	195.47
2430	711899.44	1025970.02	195.84
2431	711885.73	1025953.38	195.81
2432	711870.45	1025939.84	195.74
2433	711867.99	1025942.05	195.79
2434	711865.46	1025944.41	195.78
2435	711861.23	1025947.23	195.59
2436	711867.96	1025947.25	195.76
2437	711867.96	1025947.25	195.76
2438	711873.17	1025957.25	195.86
2439	711860.12	1025940.22	195.69
2440	711859.59	1025940.72	195.70
2441	711848.87	1025924.63	195.83
2442	711851.47	1025922.25	195.85
2443	711854.27	1025920.38	195.80
2444	711845.52	1025927.46	195.52
2445	711834.10	1025909.07	195.73

2446	711831.95	1025904.45	195.78
2447	711828.31	1025907.05	195.62
2448	711834.25	1025901.90	195.84
2449	711837.05	1025899.81	195.81
2450	711819.27	1025878.85	195.77
2451	711816.74	1025881.01	195.81
2452	711814.06	1025883.39	195.77
2453	711810.40	1025886.18	195.63
2454	711803.06	1025872.57	195.65
2455	711797.05	1025863.12	195.88
2456	711792.93	1025866.87	195.59
2457	711800.11	1025861.15	195.91
2458	711803.08	1025859.29	195.85
2459	711797.45	1025852.40	195.87
2460	711797.46	1025852.40	195.87
2461	711786.45	1025839.44	195.96
2462	711783.93	1025842.14	196.06
2463	711781.40	1025844.49	196.00
2464	711922.37	1025995.08	195.72
2465	711921.00	1025995.92	195.60
2466	711921.96	1025997.39	195.75
2467	711923.52	1025999.13	195.80
2468	711925.69	1025999.31	195.74
2469	711924.13	1025999.77	195.69
2470	711935.62	1026010.56	195.58
2471	711934.44	1026011.79	195.41
2472	711945.33	1026022.11	195.59
2473	711951.67	1026027.45	195.58
2474	711950.63	1026027.87	195.61
2475	711949.43	1026029.38	195.48
2476	711899.03	1025989.97	195.78
2477	711902.90	1025991.56	195.79
2479	711909.23	1026002.05	195.49
2480	711816.30	1025871.37	195.68
2481	711803.53	1025855.72	195.80
2482	711802.13	1025853.54	195.76
2483	711796.93	1025847.68	195.69
2484	711797.03	1025844.67	195.67
2485	711791.31	1025839.70	195.81
2486	711781.84	1025833.98	195.97
2487	711781.84	1025833.98	195.97
2488	711769.45	1025819.41	196.02
2489	711771.05	1025818.17	195.68
2490	711766.60	1025821.48	196.05
2491	711763.59	1025823.17	196.01
2492	711752.33	1025798.88	196.00
2493	711749.38	1025801.11	196.04
2494	711746.47	1025802.83	196.02
2495	711729.27	1025782.58	196.01
2496	711731.86	1025780.29	196.04
2497	711734.63	1025778.05	196.01
2498	711735.21	1025777.46	195.96
2499	711736.77	1025776.34	195.38
2500	711740.26	1025773.88	195.12
2501	711751.51	1025787.83	195.54
2502	711750.02	1025788.91	195.63
2503	711749.62	1025791.01	195.28
2504	711728.78	1025769.39	195.89
2505	711725.26	1025766.73	196.02
2506	711720.95	1025760.30	195.98
2507	711720.94	1025760.28	195.98
2508	711721.02	1025760.24	196.15
2509	711716.49	1025754.99	196.01
2510	711716.48	1025754.99	196.01
2511	711716.03	1025754.44	196.01
2512	711716.57	1025754.92	196.16
2513	711717.23	1025754.34	195.96
2514	711717.23	1025754.33	195.96

2515	711717.25	1025754.33	196.18
2516	711717.23	1025754.34	196.20
2517	711721.49	1025760.74	195.98
2518	711721.10	1025760.30	195.97
2519	711722.29	1025760.35	195.90
2520	711721.74	1025759.65	195.87
2521	711721.74	1025759.66	195.87
2522	711721.73	1025759.64	196.17
2523	711721.71	1025759.66	196.19
2524	711716.76	1025753.79	196.01
2525	711715.69	1025753.58	196.01
2526	711715.71	1025753.62	196.33
2527	711717.22	1025754.77	197.33
2528	711721.20	1025760.20	197.28
2529	711722.15	1025761.26	196.30
2530	711722.20	1025761.27	195.98
2531	711709.24	1025746.11	196.13
2532	711701.82	1025752.46	196.05
2533	711704.28	1025756.75	195.88
2534	711707.30	1025760.34	195.94
2535	711708.00	1025759.81	196.02
2536	711707.55	1025759.57	196.00
2537	711707.59	1025759.58	196.33
2538	711707.76	1025760.88	195.95
2539	711707.76	1025760.89	195.95
2540	711707.76	1025760.91	196.19
2541	711707.79	1025760.89	196.21
2542	711708.56	1025760.27	196.01
2543	711708.56	1025760.27	196.01
2544	711708.48	1025760.34	196.17
2545	711708.55	1025760.66	197.29
2546	711713.10	1025766.07	197.27
2547	711712.90	1025767.01	196.16
2548	711712.91	1025766.99	196.17
2549	711712.93	1025767.01	195.81
2550	711712.92	1025767.01	195.81
2551	711713.36	1025767.54	195.87
2552	711714.03	1025766.99	195.97
2553	711713.66	1025766.37	195.97
2554	711713.66	1025766.37	195.97
2555	711713.58	1025766.44	196.13
2556	711714.02	1025767.21	196.32
2557	711714.03	1025767.26	195.95
2558	711721.43	1025775.89	195.99
2559	711719.87	1025775.60	195.91
2560	711718.64	1025776.19	195.26
2561	711715.68	1025778.14	195.12
2562	711720.48	1025780.79	196.01
2563	711702.63	1025751.86	196.14
2564	711701.37	1025752.74	195.99
2565	711699.73	1025754.00	195.12
2566	711696.08	1025754.24	195.25
2567	711705.26	1025748.81	196.20
2568	711707.72	1025746.08	196.20
2569	711709.41	1025744.87	196.15
2570	711711.02	1025743.72	195.22
2571	711713.14	1025742.32	195.35
2572	711708.99	1025741.19	195.60
2573	711710.48	1025740.04	195.60
2574	711703.29	1025735.14	196.25
2575	711702.20	1025735.95	195.85
2576	711700.83	1025736.80	196.18
2577	711701.17	1025732.81	196.25
2578	711695.40	1025745.96	196.01
2579	711696.49	1025748.15	195.69
2580	711685.82	1025737.04	196.51
2581	711682.05	1025732.77	196.60
2582	711683.09	1025731.69	196.11

2583	711685.10	1025730.00	196.27
2584	711697.59	1025744.86	196.18
2585	711694.05	1025745.30	195.96
2586	711693.20	1025746.32	196.06
2587	711682.70	1025733.66	196.66
2588	711687.75	1025727.97	196.32
2589	711690.49	1025725.94	196.32
2590	711690.89	1025725.46	196.31
2591	711692.48	1025724.68	195.90
2592	711674.52	1025719.48	196.30
2593	711673.57	1025722.85	196.24
2594	711668.91	1025710.60	196.36
2595	711668.90	1025710.61	196.36
2596	711673.49	1025716.19	196.36
2597	711673.50	1025716.20	196.36
2598	711665.55	1025711.04	196.36
2599	711664.69	1025711.36	196.37
2600	711670.36	1025707.44	196.38
2601	711673.39	1025705.49	196.36
2602	711674.29	1025705.20	196.32
2603	711674.20	1025703.20	195.94
2604	711662.99	1025706.55	196.29
2605	711662.42	1025712.75	197.10
2606	711662.35	1025712.28	197.03
2607	711670.51	1025699.91	196.23
2608	711662.89	1025682.86	195.32
2609	711661.83	1025683.62	195.65
2610	711659.75	1025685.81	195.66
2611	711658.80	1025686.48	196.11
2612	711657.90	1025687.16	196.31
2613	711655.27	1025689.44	196.32
2614	711651.79	1025690.64	196.31
2615	711650.04	1025693.20	196.15
2616	711648.72	1025694.72	196.82
2617	711647.73	1025695.33	196.85
2618	711646.79	1025691.15	196.58
2619	711629.89	1025674.23	196.64
2620	711631.07	1025673.49	196.61
2621	711632.43	1025671.84	195.81
2622	711634.57	1025670.11	196.09
2623	711637.17	1025667.82	196.13
2624	711639.92	1025665.73	196.09
2625	711640.31	1025665.45	196.04
2626	711642.34	1025663.54	195.31
2627	711640.11	1025659.54	195.31
2628	711640.92	1025658.62	195.29
2629	711638.89	1025662.41	195.73
2630	711631.20	1025668.82	195.96
2631	711612.13	1025653.35	195.87
2632	711613.25	1025652.27	195.72
2633	711614.35	1025651.30	195.37
2634	711616.03	1025649.99	195.76
2635	711616.95	1025649.30	195.85
2636	711630.73	1025667.39	195.96
2637	711629.26	1025668.58	195.74
2638	711619.90	1025647.29	195.84
2639	711622.55	1025645.17	195.80
2640	711623.13	1025644.60	195.72
2641	711624.43	1025643.32	195.07
2642	711625.55	1025642.13	195.19
2643	711624.24	1025640.61	195.13
2644	711621.34	1025639.76	195.16
2646	711611.00	1025627.62	195.19
2647	711612.41	1025626.56	195.09
2648	711607.58	1025623.59	195.12
2649	711606.37	1025624.84	195.50
2650	711605.79	1025625.32	195.58
2651	711603.30	1025627.82	195.63

2652	711600.78	1025630.17	195.62
2653	711599.88	1025630.99	195.52
2660	711583.64	1025610.54	195.13
2661	711586.48	1025608.09	195.18
2662	711586.46	1025608.08	195.18
2663	711589.18	1025605.71	195.22
2664	711590.83	1025604.29	195.12
2666	711593.32	1025606.52	195.36
2667	711711.82	1025768.90	194.70
2668	711711.82	1025768.91	194.70
2669	711710.85	1025767.61	194.17
2670	711711.04	1025766.99	194.12
2671	711710.96	1025767.23	194.17
2672	711711.06	1025766.77	194.12
2673	711709.55	1025765.98	193.79
2674	711709.32	1025766.13	193.83
2675	711711.07	1025764.61	193.35
2676	711711.07	1025764.61	193.35
2677	711712.44	1025766.51	195.36
2678	711712.58	1025766.98	195.52
2679	711712.59	1025767.27	195.50
2680	711712.46	1025767.53	195.50
2681	711710.46	1025764.78	193.36
2682	711709.52	1025763.71	193.37
2683	711708.48	1025764.68	193.77
2684	711708.24	1025764.49	193.77
2685	711708.07	1025764.65	193.77
2686	711708.06	1025764.58	193.77
2687	711709.88	1025763.13	193.35
2688	711709.89	1025763.13	193.35
2689	711709.39	1025763.33	193.40
2690	711708.33	1025763.33	193.70
2691	711707.11	1025763.01	193.94
2692	711705.67	1025763.48	194.16
2693	711706.02	1025762.28	194.33
2694	711702.27	1025758.69	194.50
2695	711708.20	1025761.45	195.37
2696	711710.87	1025764.21	193.33
2697	711710.15	1025763.36	193.34
2698	711710.08	1025763.26	193.53
2699	711710.96	1025764.34	193.53
2700	711709.43	1025765.69	192.75
2701	711708.54	1025764.68	192.68
2702	711709.52	1025763.75	192.70
2703	711710.43	1025764.77	192.70
2704	711711.00	1025764.37	195.12
2705	711710.87	1025764.21	195.33
2706	711710.04	1025763.21	195.13
2707	711710.16	1025763.36	195.33
2708	711712.51	1025766.27	195.32
2709	711708.36	1025761.37	195.35
2710	711708.39	1025761.35	195.35
2711	711712.22	1025774.19	194.86
2712	711696.66	1025759.33	194.88
2713	711694.41	1025750.44	195.64
2714	711721.38	1025759.19	195.32
2715	711721.38	1025759.19	195.32
2716	711721.79	1025759.44	195.77
2717	711722.03	1025759.44	195.73
2718	711722.32	1025759.34	195.77
2719	711717.62	1025754.72	195.31
2720	711717.62	1025754.72	195.31
2721	711719.26	1025751.55	194.35
2722	711719.79	1025752.37	194.10
2723	711719.99	1025752.30	194.18
2724	711720.25	1025754.10	193.62
2725	711720.46	1025754.56	193.47
2726	711719.60	1025755.34	193.34

2727	711718.52	1025756.16	193.32
2728	711718.52	1025756.16	193.32
2729	711718.53	1025756.17	193.46
2730	711718.59	1025756.29	193.27
2731	711719.30	1025757.15	193.27
2732	711719.40	1025757.27	193.45
2733	711720.10	1025757.97	193.30
2734	711721.44	1025757.62	193.47
2735	711721.69	1025757.58	193.45
2736	711722.02	1025757.52	193.53
2737	711722.55	1025757.20	193.50
2738	711724.91	1025758.26	194.21
2739	711724.76	1025758.41	194.16
2740	711721.13	1025759.28	195.30
2741	711719.45	1025757.29	195.07
2742	711719.33	1025757.14	195.26
2743	711718.61	1025756.28	195.26
2744	711718.48	1025756.13	195.07
2745	711717.44	1025754.88	195.31
2746	711719.66	1025749.09	194.55
2747	711729.23	1025760.38	194.41
3001	712013.62	1026198.45	202.08
3002	712013.39	1026198.44	202.09
3003	712013.38	1026198.37	202.05
3004	712012.11	1026198.46	202.13
3005	712012.00	1026198.48	201.66
3006	712012.48	1026198.25	201.91
3007	712012.43	1026197.88	201.89
3008	712012.45	1026197.65	201.97
3009	712012.97	1026197.48	201.96
3010	712012.99	1026197.58	201.95
3011	712012.10	1026197.80	201.88
3012	712012.12	1026197.96	201.75
3013	712012.07	1026198.24	201.69
3014	712012.01	1026198.43	201.82
3015	712012.26	1026198.69	202.16
3016	712012.25	1026198.72	203.21
3017	712020.06	1026201.09	202.15
3018	712020.29	1026201.15	202.20
3019	712020.08	1026201.00	202.13
3020	712021.59	1026201.06	201.68
3021	712021.54	1026201.19	202.22
3022	712021.33	1026201.50	202.25
3023	712021.29	1026201.53	203.28
3024	712021.36	1026206.80	202.41
3025	712021.40	1026206.98	202.03
3026	712020.10	1026206.99	202.43
3027	712019.83	1026206.97	202.35
3028	712021.18	1026206.92	203.48
3029	712020.30	1026207.12	202.42
3030	712019.80	1026207.11	202.42
3031	712016.54	1026207.15	202.33
3032	712013.33	1026207.05	202.32
3033	712013.32	1026207.04	202.32
3034	712013.31	1026207.06	202.41
3035	712012.83	1026207.08	202.42
3036	712011.89	1026206.93	202.43
3037	712011.80	1026206.95	202.40
3038	712011.71	1026207.03	202.04
3039	712011.96	1026207.04	203.49
3041	712021.24	1026207.64	202.43
3042	712021.05	1026216.14	202.61
3043	712020.93	1026216.20	202.63
3044	712020.87	1026216.13	203.71
3045	712019.93	1026216.12	202.62
3046	712019.49	1026216.10	202.61
3047	712019.52	1026216.17	202.53
3048	712016.20	1026216.29	202.54

3049	712013.03	1026216.05	202.53
3050	712013.01	1026216.04	202.61
3051	712012.54	1026216.11	202.61
3052	712011.67	1026215.94	202.60
3053	712011.64	1026215.96	203.69
3054	712011.48	1026215.93	202.58
3055	712011.15	1026225.92	202.78
3056	712011.28	1026225.85	202.79
3057	712011.25	1026225.85	203.88
3058	712012.24	1026226.16	202.82
3059	712012.67	1026226.04	202.81
3060	712012.70	1026226.03	202.71
3061	712015.78	1026226.28	202.73
3062	712019.15	1026226.20	202.75
3063	712019.16	1026226.18	202.85
3064	712019.60	1026226.30	202.84
3065	712020.49	1026226.02	202.83
3066	712020.54	1026226.08	203.91
3067	712020.71	1026226.12	202.80
3068	712020.38	1026235.09	202.93
3069	712020.19	1026234.93	202.94
3070	712020.23	1026234.99	204.02
3071	712019.31	1026235.07	202.94
3072	712018.85	1026235.00	202.94
3073	712018.83	1026235.05	202.87
3074	712015.59	1026235.13	202.85
3075	712012.38	1026234.93	202.85
3076	712012.38	1026234.89	202.93
3077	712011.93	1026234.92	202.93
3078	712010.98	1026234.87	202.93
3079	712010.95	1026234.89	204.01
3080	712010.82	1026234.99	202.91
3081	712010.50	1026245.01	203.01
3082	712010.64	1026245.00	203.03
3083	712010.62	1026244.92	204.10
3084	712010.86	1026244.91	203.02
3085	712010.40	1026245.03	202.65
3086	712011.59	1026245.38	203.03
3087	712012.04	1026245.32	203.01
3088	712012.03	1026245.41	202.92
3089	712015.25	1026245.39	202.94
3090	712018.44	1026245.49	202.98
3091	712018.44	1026245.56	203.05
3092	712018.90	1026245.58	203.04
3093	712019.81	1026245.72	203.05
3094	712019.83	1026245.61	204.13
3095	712020.03	1026245.71	203.03
3096	712020.16	1026245.72	202.70
3097	712019.67	1026254.94	203.07
3098	712019.69	1026254.90	202.72
3099	712019.48	1026254.90	203.10
3100	712019.49	1026254.82	204.18
3101	712018.59	1026254.90	203.09
3102	712018.13	1026254.87	203.08
3103	712018.34	1026254.91	203.09
3104	712018.08	1026254.87	203.02
3105	712014.93	1026254.71	203.01
3106	712011.69	1026255.52	202.99
3107	712011.67	1026255.54	203.07
3108	712011.45	1026255.55	203.07
3109	712011.22	1026255.50	203.07
3110	712010.34	1026255.42	203.07
3111	712010.35	1026255.46	204.14
3112	712010.16	1026254.68	202.62
3113	712010.18	1026254.74	202.66
3114	712010.19	1026254.78	203.08
3115	712010.39	1026257.12	203.06
3116	712010.29	1026257.24	203.06

3117	712010.28	1026257.13	204.14
3118	712011.61	1026258.06	202.97
3119	712011.37	1026258.06	202.97
3120	712010.09	1026257.94	203.03
3121	712008.46	1026257.52	201.58
3122	712008.50	1026257.68	201.48
3123	712008.45	1026257.98	201.49
3124	712008.40	1026258.10	201.57
3125	712011.57	1026258.93	202.96
3126	712010.54	1026258.67	202.76
3127	712010.64	1026258.54	202.66
3128	712010.63	1026258.15	202.63
3129	712010.65	1026257.98	202.87
3130	712017.88	1026260.65	203.00
3131	712018.11	1026260.63	203.00
3132	712019.42	1026260.68	203.03
3133	712019.47	1026260.68	202.69
3134	712019.28	1026259.94	203.06
3135	712019.35	1026259.94	204.12
3136	712018.11	1026261.47	202.92
3137	712019.50	1026261.38	202.83
3138	712019.46	1026261.17	202.70
3139	712019.45	1026260.86	202.69
3140	712019.44	1026260.74	202.76
3141	712020.74	1026260.11	202.07
3142	712020.77	1026260.31	201.98
3143	712020.84	1026260.56	201.99
3144	712020.92	1026260.72	202.07
3145	712019.67	1026258.65	201.66
3146	712021.39	1026258.79	201.57
3147	711933.79	1026214.11	196.52
3148	712008.16	1026199.10	199.65
3149	712008.19	1026198.97	199.57
3150	712008.29	1026198.63	199.62
3151	712008.33	1026198.48	199.76
3160	712012.10	1026243.00	196.25
3161	712013.99	1026243.63	196.28
3162	712014.47	1026243.80	196.28
3163	712016.37	1026244.43	196.24
3164	712016.85	1026244.60	196.22
3165	712018.73	1026245.22	196.25
3166	712019.21	1026245.39	196.28
3167	712018.99	1026246.04	196.09
3168	712019.83	1026246.45	195.93
3169	712019.83	1026246.62	195.83
3170	712019.77	1026247.45	195.78
3171	712020.18	1026247.87	196.17
3172	712019.94	1026247.76	195.97
3173	712017.03	1026246.85	196.16
3174	712017.12	1026246.85	196.01
3175	712017.20	1026246.67	195.82
3176	712018.41	1026246.19	195.82
3177	712018.78	1026246.13	195.99
3178	712018.99	1026246.03	198.62
3179	712019.21	1026245.38	198.58
3180	712018.73	1026245.21	198.68
3181	712016.84	1026244.58	198.75
3182	712016.36	1026244.42	198.68
3183	712014.47	1026243.79	198.52
3184	712013.99	1026243.62	198.56
3185	712012.10	1026243.00	198.47
3187	712018.96	1026246.04	201.41
3188	712019.21	1026245.37	201.39
3189	712018.72	1026245.21	201.41
3190	712016.85	1026244.58	201.36
3191	712016.35	1026244.41	201.38
3192	712014.48	1026243.79	201.35
3193	712013.98	1026243.61	201.37

3194	712012.10	1026242.98	201.33
3195	712019.92	1026245.34	201.38
3196	712020.31	1026245.21	201.84
3197	712020.30	1026245.21	201.97
3198	712019.55	1026246.48	201.38
3199	712019.78	1026246.79	201.85
3200	712019.78	1026246.79	201.99
3201	712015.56	1026243.63	201.83
3202	712020.02	1026244.99	202.67
3203	712019.73	1026244.91	202.68
3204	712019.73	1026244.91	202.02
3205	712020.19	1026240.38	202.63
3206	712019.92	1026239.53	202.66
3207	712019.92	1026239.61	201.99
3208	712015.79	1026230.32	201.84
3209	712015.76	1026230.24	201.83
3210	712015.73	1026230.08	201.20
3211	712020.83	1026230.29	201.79
3212	712020.83	1026230.29	201.66
3213	712020.48	1026230.41	201.22
3214	712020.11	1026231.50	201.22
3215	712020.29	1026231.83	201.66
3216	712020.30	1026231.84	201.78
3217	712019.73	1026230.50	201.20
3218	712019.53	1026231.07	201.19
3219	712019.06	1026230.93	201.20
3220	712017.37	1026229.64	201.18
3221	712017.16	1026230.28	201.20
3222	712016.67	1026230.14	201.18
3223	712015.00	1026228.85	201.16
3224	712015.00	1026228.85	201.16
3225	712014.79	1026229.49	201.17
3226	712014.33	1026229.35	201.17
3227	712012.63	1026228.06	201.16
3228	712012.41	1026228.69	201.17
3229	712011.96	1026228.55	201.16
3230	712011.96	1026228.55	199.14
3231	712012.43	1026228.70	199.01
3232	712012.62	1026228.07	198.80
3233	712012.62	1026228.07	198.80
3234	712014.34	1026229.34	198.71
3235	712014.79	1026229.49	198.70
3236	712015.00	1026228.84	198.69
3237	712016.69	1026230.14	198.55
3238	712017.16	1026230.29	198.54
3239	712017.37	1026229.65	198.56
3240	712019.05	1026230.92	198.49
3241	712019.52	1026231.07	198.48
3242	712019.73	1026230.44	198.51
3243	712017.37	1026229.66	196.53
3244	712017.20	1026230.37	196.53
3245	712016.67	1026230.14	196.51
3246	712014.78	1026229.45	196.54
3247	712014.34	1026229.34	196.52
3248	712012.63	1026228.06	196.54
3249	712012.42	1026228.70	196.66
3250	712011.96	1026228.55	196.72
3251	712019.04	1026230.91	196.54
3252	712019.52	1026231.07	196.53
3253	712019.52	1026231.07	196.53
3254	712019.74	1026230.40	196.56
3255	712019.66	1026257.98	201.38
3256	712019.63	1026257.84	201.88
3257	712019.63	1026257.83	202.69
3258	712019.54	1026257.81	202.69
3259	712019.29	1026257.65	202.08
3260	712019.26	1026257.72	202.74
3261	712019.28	1026257.69	202.09

3262	712019.26	1026257.70	202.03
3263	712019.21	1026257.69	201.88
3264	712019.15	1026257.91	201.42
3265	712019.80	1026254.72	199.75
3266	712015.09	1026256.40	202.06
3267	712015.09	1026256.40	202.09
3268	712015.17	1026256.33	201.88
3269	712015.06	1026256.53	201.43
3270	712019.58	1026257.12	199.90
3271	712019.72	1026252.77	202.72
3272	712019.50	1026253.17	202.76
3273	712019.43	1026252.98	202.09
3274	712064.14	1026257.91	196.32
3275	712073.61	1026258.90	196.36
3276	712081.92	1026257.39	196.45
3277	712095.97	1026257.67	196.53
3278	712094.89	1026257.49	196.53
3279	712079.18	1026250.44	196.83
3280	712056.30	1026242.97	196.81
3281	712054.12	1026243.97	196.53
3282	712048.27	1026246.33	196.45
3283	712045.33	1026249.64	196.36
3284	712045.75	1026251.90	196.31
3285	712053.51	1026242.02	196.79
3286	712027.51	1026245.92	196.33
3287	712028.58	1026244.12	196.37
3288	712029.52	1026240.19	196.46
3289	712031.12	1026236.28	196.55
3290	712034.28	1026236.17	196.85
3291	712000.42	1026236.88	196.38
3292	711999.23	1026234.36	196.42
3293	711997.81	1026229.64	196.50
3294	711993.13	1026223.67	196.61
3296	711991.54	1026221.58	196.90
3297	711976.38	1026216.19	196.90
3298	711978.27	1026218.70	196.64
3299	711980.89	1026223.94	196.54
3300	711976.54	1026226.72	196.47
3301	711971.62	1026226.92	196.44
3303	712064.73	1026260.20	196.12
3304	712064.25	1026261.38	195.69
3305	712058.02	1026263.32	197.32
3306	712048.32	1026262.05	197.96
3307	712049.18	1026258.95	196.86
3308	712049.68	1026256.47	195.67
3309	712049.85	1026255.47	196.12
3310	712032.39	1026249.87	196.11
3311	712031.85	1026250.96	195.79
3312	712029.34	1026252.06	196.43
3313	712029.76	1026257.67	197.61
3314	712031.03	1026259.46	197.81
3315	712030.64	1026248.04	196.27
3316	712005.40	1026239.63	196.31
3317	711964.11	1026225.86	196.23
3318	711964.00	1026226.52	195.99
3319	711963.40	1026228.15	196.85
3320	711981.68	1026231.90	196.27
3321	711981.43	1026232.60	195.90
3322	711980.83	1026234.04	196.87
3323	711979.79	1026232.40	195.88
3324	711979.99	1026232.55	196.00
3325	711978.65	1026232.12	196.10
3326	711978.92	1026232.07	195.85
3327	711978.43	1026233.26	196.99
3328	711978.59	1026233.35	196.91
3329	711979.60	1026233.71	197.09
3330	711979.45	1026233.67	196.94
3331	711994.19	1026238.89	196.54

3332	711997.14	1026240.62	196.68
3333	711999.26	1026242.63	196.82
3334	711999.75	1026241.26	196.44
3335	712000.29	1026239.98	195.74
3336	712000.95	1026239.24	196.18
3337	712004.91	1026248.02	197.83
3338	712009.93	1026254.91	201.31
3339	712010.11	1026254.81	201.16
3340	712010.15	1026254.66	201.87
3342	712010.23	1026254.69	202.66
3343	712010.48	1026254.78	202.72
3344	712010.49	1026254.78	202.02
3345	712010.49	1026254.79	202.04
3346	712010.49	1026254.78	201.87
3347	712010.25	1026254.17	201.05
3348	712010.29	1026251.35	199.61
3349	712010.43	1026244.67	196.23
3350	712010.41	1026244.61	196.03
3351	712010.47	1026244.49	195.92
3352	712010.65	1026243.62	195.81
3353	712010.71	1026243.46	195.96
3354	712011.41	1026243.48	196.16
3355	712011.62	1026242.85	196.28
3356	712011.64	1026242.85	198.24
3357	712011.42	1026243.49	198.25
3358	712011.40	1026243.48	201.34
3359	712011.61	1026242.82	201.34
3360	712010.31	1026243.63	201.79
3361	712010.29	1026243.61	201.93
3362	712010.67	1026243.49	201.35
3363	712011.05	1026242.37	201.35
3364	712010.83	1026242.06	201.80
3365	712010.84	1026242.05	201.94
3366	712010.42	1026247.95	202.67
3367	712010.70	1026248.26	202.73
3368	712010.71	1026248.07	202.05
3369	712010.54	1026243.90	202.62
3370	712010.84	1026244.08	202.69
3371	712010.84	1026243.95	201.99
3372	712013.99	1026243.62	201.36
3373	712016.37	1026244.42	201.36
3374	712018.73	1026245.21	201.37
3375	712010.76	1026237.10	202.57
3376	712011.09	1026236.91	202.62
3377	712011.10	1026236.91	201.94
3378	712010.85	1026228.70	201.75
3379	712010.85	1026228.70	201.62
3380	712011.18	1026228.58	201.21
3381	712011.06	1026228.28	202.45
3382	712011.07	1026228.28	202.45
3383	712011.41	1026228.17	202.50
3384	712011.38	1026228.97	201.81
3385	712011.38	1026228.88	201.76
3386	712020.13	1026231.76	201.85
3387	712020.09	1026231.76	201.79
3388	712019.17	1026230.32	196.56
3389	712016.67	1026230.13	196.51
3390	712016.89	1026229.48	196.54
3391	712014.51	1026228.69	196.52
3392	712012.15	1026227.89	196.63
3393	712019.24	1026230.27	198.82
3394	712016.87	1026229.49	198.35
3395	712014.51	1026228.71	198.32
3396	712012.14	1026227.92	198.30
3397	712019.24	1026230.28	201.18
3398	712016.87	1026229.52	201.18
3399	712014.51	1026228.70	201.18
3400	712012.13	1026227.90	201.16

3401	712003.16	1026254.11	198.17
3402	712015.67	1026230.19	201.80
3403	712015.56	1026230.27	201.64
3404	712015.63	1026230.04	201.19
3405	712011.37	1026227.09	201.76
3406	712011.37	1026227.10	201.63
3407	712011.60	1026227.45	201.19
3408	712011.43	1026227.12	201.78
3409	712016.19	1026228.82	201.83
3410	712016.10	1026228.66	201.66
3411	712016.05	1026228.91	201.19
3412	712012.15	1026227.87	196.70
3413	712011.41	1026218.19	202.28
3414	712011.73	1026218.40	202.32
3415	712011.72	1026218.31	201.65
3416	712012.68	1026212.88	195.96
3417	712012.46	1026213.53	196.19
3418	712014.82	1026214.31	196.10
3419	712014.82	1026214.32	196.11
3420	712015.29	1026214.49	196.11
3421	712017.18	1026215.12	196.05
3422	712017.66	1026215.28	196.13
3423	712019.55	1026215.90	195.99
3424	712020.04	1026216.07	196.15
3425	712012.47	1026213.54	198.11
3426	712012.94	1026213.70	198.07
3427	712014.81	1026214.31	198.05
3428	712015.29	1026214.49	198.02
3429	712017.18	1026215.12	197.93
3430	712017.66	1026215.28	197.93
3431	712019.56	1026215.89	197.93
3432	712020.03	1026216.07	197.94
3433	712012.50	1026213.55	200.90
3434	712012.95	1026213.70	200.90
3435	712014.82	1026214.31	200.88
3436	712017.17	1026215.12	200.90
3437	712019.55	1026215.91	200.92
3438	712011.72	1026213.57	200.90
3439	712011.35	1026213.70	201.33
3440	712011.34	1026213.69	201.45
3441	712012.08	1026212.40	200.92
3442	712011.90	1026212.12	201.35
3443	712011.87	1026212.10	201.47
3444	712011.86	1026213.87	201.51
3445	712011.93	1026213.29	202.25
3446	712011.58	1026213.16	202.17
3447	712011.93	1026212.08	201.50
3448	712012.67	1026212.88	200.90
3449	712039.66	1026224.76	196.31
3450	712042.30	1026228.02	196.36
3451	712042.59	1026232.27	196.45
3452	712037.27	1026234.76	196.53
3453	712034.46	1026235.32	196.86
3454	712016.51	1026228.99	196.72
3455	712015.84	1026227.79	196.56
3456	712019.79	1026224.75	196.46
3457	712019.14	1026220.35	196.39
3458	712016.26	1026216.92	196.34
3459	711996.69	1026210.50	196.37
3460	711993.43	1026211.81	196.42
3461	711989.85	1026214.78	196.51
3462	711985.36	1026217.63	196.61
3463	711984.02	1026218.73	196.90
3464	711984.03	1026218.73	196.90
3465	711972.66	1026214.89	196.97
3466	711958.12	1026209.82	197.20
3467	711953.68	1026206.68	196.68
3468	711957.75	1026203.91	196.59

3469	711964.40	1026201.97	196.49
3470	711963.86	1026199.59	196.45
3471	711959.88	1026196.81	196.34
3472	711960.53	1026195.79	196.08
3473	711960.80	1026195.14	196.43
3474	711980.33	1026204.11	196.31
3475	711980.78	1026202.37	195.82
3476	711980.97	1026201.63	196.18
3477	712001.26	1026210.90	196.29
3478	712011.09	1026211.08	195.96
3479	712014.25	1026213.38	196.04
3480	712011.14	1026212.26	195.82
3481	712011.11	1026212.09	195.72
3482	712011.21	1026211.47	195.70
3483	712011.25	1026211.33	195.82
3484	712005.86	1026207.21	196.87
3485	712003.57	1026202.02	197.31
3486	712011.95	1026211.27	195.92
3487	712014.79	1026212.12	195.94
3488	712014.75	1026212.13	195.87
3489	712014.59	1026212.34	195.71
3490	712013.93	1026212.89	195.71
3491	712013.24	1026212.84	195.83
3492	712011.57	1026207.07	197.95
3493	712012.01	1026202.79	200.40
3494	712011.96	1026200.91	200.66
3495	712011.96	1026200.91	200.66
3496	712012.02	1026201.12	201.84
3497	712012.28	1026201.20	201.89
3498	712012.01	1026201.12	201.02
3499	712012.22	1026201.19	201.16
3500	712012.22	1026201.18	201.21
3501	712016.52	1026202.61	201.19
3502	712016.54	1026202.62	201.08
3503	712016.54	1026202.60	201.24
3504	712012.20	1026203.91	201.31
3505	712012.20	1026203.50	201.99
3506	712011.92	1026203.81	201.94
3507	712020.77	1026223.60	202.40
3508	712020.48	1026224.02	202.46
3509	712020.48	1026223.51	201.75
3510	712020.26	1026230.10	201.84
3511	712020.27	1026230.05	201.79
3512	712016.03	1026228.72	201.82
3513	712016.07	1026228.65	201.78
3514	712011.51	1026227.14	201.80
3515	712011.51	1026227.15	201.75
3516	712020.82	1026216.85	201.52
3517	712020.82	1026216.85	201.40
3518	712020.61	1026216.54	200.97
3519	712020.04	1026216.08	200.94
3520	712017.60	1026215.26	200.93
3521	712015.26	1026214.49	200.90
3522	712021.35	1026215.27	201.52
3523	712021.34	1026215.26	201.39
3524	712020.98	1026215.39	200.96
3525	712020.28	1026215.44	200.94
3526	712021.00	1026216.86	202.26
3527	712020.69	1026216.82	202.28
3528	712020.70	1026216.85	201.60
3529	712020.77	1026214.77	201.58
3530	712021.17	1026211.92	202.16
3531	712020.89	1026211.97	202.22
3532	712020.86	1026212.58	201.54
3533	712020.25	1026215.41	198.19
3534	712020.26	1026215.42	195.93
3535	712020.04	1026216.07	196.10
3536	712020.04	1026216.06	197.98

3537	712017.69	1026215.55	200.91
3538	712017.43	1026215.71	201.35
3539	712063.75	1026233.06	196.31
3540	712064.65	1026235.40	196.35
3541	712059.68	1026237.93	196.44
3542	712066.22	1026244.30	196.51
3543	712070.96	1026247.55	197.07
3544	712066.39	1026233.92	196.32
3545	712080.60	1026240.68	196.35
3546	712076.84	1026243.60	196.43
3547	712089.04	1026253.55	197.05
3548	712020.49	1026215.37	195.89
3549	712022.76	1026215.52	195.60
3550	712023.94	1026215.22	195.83
3551	712044.57	1026222.06	195.73
3552	712044.38	1026222.73	195.47
3553	712060.05	1026227.78	195.57
3554	712061.82	1026227.78	195.80
3555	712079.99	1026233.66	195.71
3556	712079.74	1026234.15	195.41
3557	712020.22	1026214.61	195.64
3558	712020.48	1026214.77	195.64
3559	712021.27	1026214.27	195.78
3560	712021.24	1026214.42	195.72
3561	712021.32	1026213.96	195.91
3562	712021.75	1026210.66	197.55
3563	712021.49	1026205.25	200.41
3564	712021.54	1026204.01	200.63
3565	712021.54	1026204.01	200.63
3566	712021.51	1026204.27	201.08
3567	712021.45	1026204.24	201.93
3568	712021.14	1026204.13	201.96
3569	712021.15	1026204.14	201.22
3570	712021.15	1026204.14	201.22
3571	712021.15	1026204.14	201.22
3572	712021.15	1026204.14	201.28
3573	712021.15	1026204.14	201.28
3574	712029.23	1026209.19	196.99
3575	712027.71	1026213.80	196.16
3576	712021.41	1026213.56	196.20
3577	712026.48	1026219.48	196.14
6001	712021.55	1026202.25	201.81
1001	713154.40	1026812.70	205.56
1002	713153.62	1026812.56	205.55
1003	713158.68	1026803.22	205.27
1004	713181.52	1026798.74	204.52
1005	713184.03	1026800.71	204.26
1006	713187.82	1026796.12	203.73
1007	713186.27	1026794.73	204.06
1008	713278.66	1026816.05	204.47
1009	713278.70	1026810.92	204.43
1010	713268.62	1026812.32	204.78
1011	713269.70	1026813.23	204.87
1012	713248.76	1026806.51	204.37
1013	711668.64	1025715.81	196.46
1014	711669.01	1025715.69	196.39
1015	711670.09	1025716.57	196.36
1016	711668.72	1025717.71	196.97
1017	711666.40	1025717.18	196.71
1018	711664.20	1025715.10	196.76
1019	711675.61	1025704.37	195.98
1020	711677.16	1025703.79	196.23
1021	711679.98	1025702.00	195.87
1022	711679.70	1025705.12	196.35
1023	711683.41	1025709.68	196.59
1024	711689.05	1025712.56	196.07
1025	711686.58	1025714.98	196.39
1026	711685.35	1025716.11	195.96

1027	711691.45	1025719.87	196.55
1028	711697.04	1025725.40	196.77
1029	711700.86	1025727.23	196.20
1030	711699.03	1025729.68	196.44
1031	711697.92	1025731.14	195.99
1032	711732.86	1025769.53	194.79
1033	711731.18	1025767.30	194.80
1034	711735.33	1025768.13	194.86
1035	711752.33	1025792.41	195.51
1036	711755.36	1025798.40	195.22
1037	711756.60	1025796.87	195.83
1038	711758.07	1025795.90	195.71
1039	711758.71	1025799.95	196.01
1040	711772.72	1025815.85	196.13
1041	711776.45	1025818.05	195.81
1042	711775.12	1025818.79	195.78
1043	711773.62	1025820.42	195.63
1044	711776.86	1025822.39	195.59
1045	711780.59	1025825.84	195.87
1046	711779.48	1025827.38	195.69
1047	711788.18	1025837.80	195.63
1048	711791.30	1025837.42	195.83
1049	711794.36	1025837.96	195.51
1050	711798.00	1025842.71	195.51
1051	711807.22	1025860.06	195.40
1052	711808.76	1025859.46	195.43
1053	711810.52	1025858.42	195.05
1054	711816.01	1025870.49	195.30
1055	711824.05	1025879.31	194.86
1056	711821.70	1025877.47	195.13
1057	711821.42	1025875.20	195.00
1058	711826.55	1025876.96	193.93
1059	711826.53	1025877.00	193.95
1060	711838.14	1025898.20	195.49
1061	711841.50	1025894.90	193.31
1064	711857.60	1025914.46	193.77
1065	711870.70	1025930.02	194.20
1066	711869.19	1025931.57	194.52
1067	711866.42	1025934.13	195.70
1068	711854.62	1025920.15	195.77
1069	711879.11	1025944.57	195.03
1070	711883.62	1025945.69	194.74
1071	711889.57	1025955.04	195.31
1072	711890.44	1025954.06	195.04
1073	711898.79	1025965.95	195.61
1074	711899.76	1025965.15	195.49
1075	711955.06	1026033.53	195.61
1076	711957.16	1026033.09	195.52
1077	711980.75	1026059.97	195.54
1078	711983.55	1026057.84	195.36
1079	711984.77	1026063.82	195.75
1080	711986.51	1026065.58	195.73
1081	711896.61	1025993.23	195.93
1082	711769.90	1025833.42	195.91
1083	711768.76	1025834.53	195.65
1084	711766.38	1025835.62	195.93
1085	711765.63	1025836.29	195.83
1086	711765.09	1025831.96	196.27
1087	711761.65	1025827.83	195.61
1088	711753.06	1025816.13	195.56
1089	711751.10	1025813.86	195.62
1090	711748.40	1025815.49	195.93
1091	711748.01	1025815.73	195.83
1092	711743.76	1025804.95	195.70
1093	711742.26	1025806.16	195.86
1094	711740.85	1025807.27	195.92
1095	711740.52	1025803.99	195.87
1096	711738.66	1025795.58	195.99

1097	711731.15	1025792.68	195.74
1098	711733.93	1025793.30	195.66
1099	711728.24	1025787.82	195.43
1100	711725.00	1025781.34	195.92
1101	711727.19	1025783.18	196.00
1102	711725.86	1025784.31	195.56
1103	711723.52	1025787.12	195.58
1104	711598.65	1025632.34	195.16
1105	711596.22	1025634.40	195.77
1106	711606.51	1025643.78	195.90
1107	711584.83	1025614.96	195.22
1108	711583.40	1025616.19	195.11
1109	711579.94	1025614.61	195.39
1110	711579.28	1025615.02	195.49
1111	711580.12	1025615.58	195.38
1112	711580.81	1025616.36	195.39
1113	711581.82	1025617.55	195.36
1114	711581.89	1025617.99	195.54
1115	711583.95	1025620.10	195.44
1117	711584.48	1025620.18	195.38
1118	711586.20	1025619.72	195.36
1119	711586.01	1025617.11	195.33
1120	711588.38	1025617.54	195.31
1121	711587.66	1025618.95	195.06
1122	711645.61	1025663.52	195.15
1123	711650.72	1025670.67	195.28
1124	711654.05	1025674.81	195.23
1125	711658.54	1025681.41	196.10
1126	711669.81	1025694.88	195.69
1127	711673.14	1025700.40	195.99
1128	711660.17	1025715.55	197.13
2056	712179.97	1026561.26	206.81
2102	712148.95	1026550.37	206.22

2	712027.81	1026158.67	196.50
3	712031.18	1026172.56	197.00
4	712032.46	1026183.66	196.91
5	712031.72	1026199.36	196.81
6	712027.87	1026276.16	198.63
7	712027.59	1026292.07	198.81
8	712027.13	1026305.49	199.27
9	712026.43	1026321.65	199.63
10	712005.63	1026310.03	199.95
11	712003.26	1026293.87	199.37
12	712001.98	1026277.95	199.02
14	712003.37	1026192.59	197.49
15	712002.61	1026176.68	197.11